

61G15-32.004 DESIGN OF WATER BASED FIRE PROTECTION SYSTEMS.

- (1) WATER BASED FIRE PROTECTION SYSTEMS INCLUDE, BUT ARE NOT LIMITED TO, AUTOMATIC SPRINKLER SYSTEMS OF WET, DRY, FINE WATER SPRAY (MIST), MANUAL AND DELUGE VALVE CONTROLLED TYPES, PUMPING SYSTEMS, STANDPIPES, FIRE WATER MAINS AND DEDICATED FIRE PROTECTION WATER SOURCES.
- (2) TO ENSURE MINIMUM DESIGN QUALITY IN FIRE PROTECTION SYSTEM ENGINEERING DOCUMENTS, SAID DOCUMENTS SHALL INCLUDE AS A MINIMUM THE FOLLOWING INFORMATION WHEN APPLICABLE:
- (A) THE POINT OF SERVICE FOR THE FIRE PROTECTION WATER SUPPLY AS DEFINED BY SECTION 633.021(18), F.S.
- THE POINT OF SERVICE AND FIRE DEPARTMENT CONNECTION IS LOCATED ON CIVIL DRAWINGS
- (B) APPLICABLE NFPA STANDARD TO BE APPLIED, OR IN THE CASE WHERE NO SUCH STANDARD EXISTS, THE ENGINEERING STUDY, JUDGEMENTS, AND/OR PERFORMANCE BASED ANALYSIS AND CONCLUSIONS.
- NFPA 13R, 2013 EDITION, INSTALLATION OF SPRINKLER SYSTEMS
NFPA 24, 2010 EDITION, INSTALLATION OF FIRE SERVICE MAINS.
- (C) CLASSIFICATION OF HAZARD OCCUPANCY FOR EACH ROOM OR AREA.
- SYSTEM DESIGNED PER NFPA 13R USING A 0.05 GPM/SQ FT FOR ALL DWELLING UNITS (RESIDENTIAL OCCUPANCY) USING RESIDENTIAL SPRINKLERS.
- (D) DESIGN APPROACH, WHICH INCLUDES SYSTEM TYPE, DENSITIES, DEVICE TEMPERATURE RATING, AND SPACING FOR EACH SEPARATE HAZARD OCCUPANCY.
- SPRINKLER SYSTEM TO EXTEND INTO ALL AREAS IN ACCORDANCE WITH NFPA 13R LISTED AND APPROVED UPRIGHT SPRINKLER HEADS TO BE PROVIDED. SEE FIRE PROTECTION SCHEDULE ON THIS SHEET. HEADS SHALL BE RATED AT 155 DEGREES F.
- (E) CHARACTERISTICS OF WATER SUPPLY TO BE USED, SUCH AS MAIN SIZE AND LOCATION, WHETHER IT IS DEAD-END OR CIRCULATING; AND IF DEAD-END, THE DISTANCE TO THE NEAREST CIRCULATING MAIN, AS WELL AS ITS MINIMUM DURATION AND RELIABILITY FOR THE MOST HYDRAULICALLY DEMANDING DESIGN AREA
- THE WATER SUPPLY FOR THIS SPRINKLER SYSTEM IS PROVIDED BY A 10 INCH PRIVATELY OWNED WATER MAIN. THE DURATION FOR THE MOST REMOTE HYDRAULICALLY DEMANDING AREA IS 100 G.P.M. FOR 60 MINUTES.
- (F) WHEN PRIVATE OR PUBLIC WATER SUPPLIES ARE USED, THE FLOW TEST DATA, INCLUDING TIME AND DATE OF TEST, WHO CONDUCTED THE TEST OR SUPPLIED INFORMATION, TEST ELEVATION, STATIC GAUGE PRESSURE AT NO FLOW, FLOW RATE WITH RESIDUAL GAUGE PRESSURE, HYDRANT BUTT COEFFICIENT, AND LOCATION OF THE TEST IN RELATION TO THE HYDRAULIC POINT OF SERVICE.
- PROVIDED BY SPRINKLER CONTRACTOR.
- (G) VALVING AND ALARM REQUIREMENTS TO MINIMIZE POTENTIAL FOR IMPAIRMENTS AND UNRECOGNIZED FLOW OF WATER.
- THE FIRE SPRINKLER RISER FOR THE BUILDING WILL BE EQUIPPED WITH A WATER FLOW SWITCH WITH A LOCAL ALARM AND OFF-SITE MONITORING.
- (H) MICROBIAL INDUCED CORROSION (MIC). THE ENGINEER OF RECORD SHALL MAKE REASONABLE EFFORTS TO IDENTIFY WATER SUPPLIES THAT COULD LEAD TO MICROBIAL INDUCED CORROSION (MIC). SUCH EFFORTS MAY CONSIST OF DISCUSSIONS WITH LOCAL WATER PURVEYOR AND/OR FIRE OFFICIAL, FAMILIARITY WITH CONDITIONS IN THE LOCAL AREA, OR LABORATORY TESTING OF WATER SUPPLIES. WHEN CONDITION ARE FOUND THAT MAY RESULT IN MIC CONTAMINATION OF THE FIRE PROTECTION PIPING, THE ENGINEER SHALL DESIGN CORRECTIVE MEASURES.
- BASED ON DISCUSSIONS WITH THE LOCAL WATER UTILITIES, THERE HAVE BEEN NO INDICATIONS OF M.I.C.
- (I) BACKFLOW PREVENTION AND METERING SPECIFICATIONS AND DETAILS TO MEET LOCAL WATER PREVENTER REQUIREMENTS INCLUDING MAXIMUM ALLOWABLE PRESSURE DROP.
- THE BACKFLOW PREVENTION DEVICE ASSEMBLY AND METERING EQUIPMENT WILL MEET THE REQUIREMENTS OF THE LOCAL WATER PURVEYOR. MAX. PRESSURE DROP 8 PSI.
- (J) QUALITY AND PERFORMANCE SPECIFICATIONS OF ALL YARD AND INTERIOR FIRE PROTECTION COMPONENTS.
- ALL NEW YARD AND INTERIOR FIRE PROTECTION EQUIPMENT SHALL BE U.L. LISTED AND F.M. APPROVED.
- (3) CONTRACTOR SUBMITTALS WHICH DEViate FROM THE ABOVE MINIMUM DESIGN PARAMETERS SHALL BE CONSIDERED MATERIAL DEVIATIONS AND REQUIRE SUPPLEMENTAL ENGINEERING APPROVAL AND DOCUMENTATION.
- THE SUCCESSFUL FLORIDA LICENSED FIRE PROTECTION CONTRACTOR SHALL SUBMIT FIRE PROTECTION SHOP DRAWINGS AS NEEDED TO FULFILL THE REQUIREMENTS FOR A FIRE SPRINKLER PERMIT.
- (4) IN THE EVENT THE ENGINEER OF RECORD PROVIDES MORE INFORMATION AND DIRECTION THAN IS ESTABLISHED ABOVE, HE OR SHE SHALL BE HELD RESPONSIBLE FOR THE TECHNICAL ACCURACY OF THE WORK IN ACCORDANCE WITH APPLICABLE CODES, STANDARDS, AND SOUND ENGINEERING PRINCIPLES.
- (5) THE UNDERGROUND AND INSIDE PIPING SHALL BE HYDROSTATICALLY TESTED AT 200 PSI FOR 2 HOURS PER 10.2.1
- (6) THE FIRE PROTECTION CONTRACTOR SHALL COMPLY WITH CHAPTER 10 SECTION 10.2:
- A. ALL UNDERGROUND PIPING FROM THE WATER MAIN TO THE RISER SHALL BE COMPLETELY FLUSHED. THE FLUSHING SHALL CONTINUE FOR SUFFICIENT TIME TO ENSURE CLEANING.
- B. THE MINIMUM FLOW SHALL NOT BE LESS THAN: HYDRAULICALLY CALCULATED DEMAND INCLUDING HOSE STREAM ALLOWANCE, FLOW RATE AVAILABLE UNDER FIRE CONDITIONS.
- (7) ALL PIPING AND APPURTENANCES SHALL BE PRESSURE TESTED AT 200 PSI OR 50 PSI IN EXCESS OF SYSTEM PRESSURE, WHICH EVER IS GREATER, FOR A MINIMUM OF 2 HOURS WITH OUT ANY LOSSES.

| FIRE PROTECTION SCHEDULE | | | | | | | |
|--------------------------|--------------|-----------------------|--------------|----------|--------|------------------|---------------------------------|
| SYMBOL | TEMP. RATING | TYPE | ORIFICE SIZE | K-FACTOR | FINISH | ACCESSORIES | SELECTION |
| ● | 155°F | SEMI-RECESSED PENDENT | 1/2" | 4.9 | WHITE | WHITE ESCUTCHEON | TYCO RAPID RESPONSE SERIES LFII |
| ● | 155°F | SEMI-RECESSED PENDENT | 1/2" | 5.6 | WHITE | WHITE ESCUTCHEON | TYCO RAPID RESPONSE SERIES LFII |
| ◀ | 155°F | HORIZONTAL SIDEWALL | 1/2" | 4.2 | CHROME | - | TYCO RAPID RESPONSE SERIES LFII |

| HANGER SPACING FOR CPVC PIPING | |
|--------------------------------|---------------------|
| NOMINAL PIPE SIZE (INCHES) | MAX. SPACING (FEET) |
| 3/4" | 5-1/2 |
| 1" | 6 |
| 1-1/4" | 6-1/2 |
| 1-1/2" | 7 |
| 2" | 8 |
| 2-1/2" | 9 |
| 3" | 10 |

FIRE PROTECTION SPRINKLER DESIGN

- THESE DRAWINGS ARE INTENDED TO ILLUSTRATE THE DESIGN INTENT AND AID IN THE COORDINATION OF ELEMENTS OF A FIRE PROTECTION SPRINKLER DESIGN.
- THE DESIGN OF THE FIRE PROTECTION SPRINKLER SYSTEM SHALL BE PROVIDED IN ACCORDANCE WITH THE REQUIREMENTS OF THE AUTHORITY HAVING JURISDICTION AND THE APPLICABLE STANDARDS FROM THE NATIONAL FIRE PROTECTION ASSOCIATION (NFPA).
- THE FIRE PROTECTION SPRINKLER DESIGN SHALL BE COORDINATED WITH OTHER ASPECTS OF THE BUILDING DESIGN INCLUDING, BUT NOT LIMITED TO, FIRE ALARM, ELECTRICAL POWER AND LIGHTING, REFLECTED CEILING, DUCTWORK, PLUMBING AND THE BUILDING STRUCTURAL SYSTEM.
- THE FIRE PROTECTION SPRINKLER DESIGN DRAWINGS SHALL BE SUBMITTED FOR COORDINATION PRIOR TO INSTALLATION OF THE SYSTEM. INSTALLATION WITHOUT COORDINATION WILL BE AT THE CONTRACTOR'S RISK AND REWORK OF THE SYSTEM SHALL BE PROVIDED WITHOUT ADDITIONAL COST.
- APPLICABLE FIRE CODES, FLORIDA FIRE PREVENTION CODE FIFTH EDITION, BASED ON NFPA 1, FIRE CODE, 2013 EDITION AND NFPA 101, LIFE SAFETY CODE, 2013 EDITION.
- A STATE OF FLORIDA LICENSED FIRE SPRINKLER CONTRACTOR SHALL PROVIDE THE LAYOUT DOCUMENTS.

GENERAL NOTES

- ALL WORK & MATERIAL SHALL BE DONE IN ACCORDANCE WITH NFPA 13R AND THE LOCAL AUTHORITY.
- ALL PIPE AND FITTINGS TO BR CPVC, UNLESS NOTER OTHERWISE EXCEPT FOR THE BLDG. RISER WHICH SHALL BE SCHEDULE 40 GALVANIZED STEEL.
- ALL RESIDENTIAL SPRINKLER HEAD SPACING TO BE IN ACCORDANCE WITH THE MANUFACTURER'S LISTING.
- ALL FIREWALL PENETRATIONS TO BE SEALED IN ACCORDANCE WITH THEIR RATING.
- PROVIDE SIGN ON DOOR INDICATING "FIRE RISER INSIDE".
- ALL FIRE SPRINKLER WORK, INCLUDING CHANGES, ADDITIONS, RELOCATIONS, IMPROVEMENTS, AND/OR MODIFICATIONS TO THE FIRE SPRINKLER SYSTEM, MUST BE DONE PER NFPA-13 2013 EDITION, BY A LICENSED FIRE SPRINKLER CONTRACTOR WITH SEPARATE PERMIT AND PLANS.

DESIGN CRITERIA

- THE NUMBER OF DESIGN SPRINKLERS SHALL INCLUDE ALL SPRINKLERS WITHIN A COMPARTMENT UP TO A MINIMUM OF FOUR SPRINKLERS UNDER A FLAT, SMOOTH, HORIZONTAL CEILING, ANY LINTEL WITH 8" MINIMUM WILL DIVIDE AN AREA INTO TWO COMPARTMENTS.

| FIRE PROTECTION SYMBOL LEGEND | |
|-------------------------------|------------------------------------|
| F | FIRE PROTECTION SUPPLY PIPING |
| TS | SOLENOID VALVE WITH TAMPER SWITCH |
| TS | BUTTERFLY VALVE WITH TAMPER SWITCH |
| FS | FLOW SWITCH |
| FDC | FIRE DEPARTMENT CONNECTION PIPING |
| — | PIPE HANGER |
| PIV | POST INDICATING VALVE |
| CD | FIRE DEPT. CONNECTION |

| ABBREVIATIONS | |
|---------------|---|
| CONT. | CONTINUATION |
| ETR | EXISTING TO REMAIN |
| N | NEW HEAD |
| F | FIRE |
| FH | FIRE HYDRANT |
| FDC | FIRE DEPARTMENT CONNECTION |
| FS | FLOW SWITCH |
| GPM | GALLONS PER MINUTE |
| PSI | POUNDS PER SQUARE INCH (WATER PRESSURE) |
| PIV | POST INDICATING VALVE |
| R | RELOCATE HEAD |
| TS | TAMPER SWITCH |

| FIRE HYDRANT FLOW TEST DATA | |
|-----------------------------|--------------------------------------|
| TEST DATE: | 6/17/16 |
| TEST BY: | FORT MYERS FIRE DEPARTMENT |
| THE FLOW HYDRANT | #314425H045 |
| LOCATION: | SHOEMAKER LANE FORT MYERS FLORIDA |
| STATIC PRESSURE | 56 PSI |
| RESIDUAL PRESSURE: | 48 PSI |
| FLOW: | 2226 GPM |
| PITOT SIZE: | 2-1/2" |

GENERAL NOTES

- A CURRENT FIRE HYDRANT FLOW TEST HAS BEEN REQUESTED TO BE PERFORMED BY THE FORT MYERS FIRE DEPARTMENT AND THE RESULTS WHEN RECEIVED WILL BE PROVIDED.



CITY OF FORT MYERS

THIS PLAN REVIEWED FOR SUBSTANTIAL CODE COMPLIANCE WITH ALL APPLICABLE CODES.

DATE APPROVED: 06/17/20
PERMIT NUMBER: BL2020-00848
PROPERTY ADDRESS: 3815 OLD BERRY POINT

JOB DESCRIPTION: New construction of a 3 story apartment building that includes 77 units of 4, 5, 6 and 8 direct entry direct entry garage units. The building provides

| ISSUE HISTORY | | |
|------------------|----------|--------------------------|
| No. | Date | Description |
| 1 | 11/22/19 | SCHEMATIC DESIGN |
| 2 | 12/06/19 | DESIGN DEVELOPMENT |
| 3 | 02/28/20 | PERMIT REVIEW SET |
| REVISION HISTORY | | |
| No. | Date | Description |
| 2 | 06/03/20 | PERMIT COMMENT RESPONSES |
| | | |
| | | |
| | | |
| | | |
| | | |
| | | |
| | | |
| | | |



FUGLEBERG KOCH
PLLC

2555 Temple Trail, Winter Park, FL 32789 (407) 629-0595
www.fuglebergkoch.com BR569



SALAS O'BRIEN
CONSULTANT
Expect a difference

2001 Quatrefoil Boulevard, Suite 100
Orlando, Florida 32817
CERT. OF AUTH. NO. 6106
■ DAVID A. WALKERSON, P.E. #1917
■ BENJAMIN J. CARTER, P.E. #3089
■ JEFF A. KIRKMAN, P.E. #8519
■ CHARLES S. LEVINE, P.E. #7709

THIS ITEM HAS BEEN ELECTRONICALLY SIGNED AND SEALED BY JEFFREY A. KIRKMAN, PE ON DATE INDICATED IN DIGITAL SIGNATURE USING A DIGITAL SIGNATURE.

PRINTED COPIES OF THIS DOCUMENT ARE NOT CONSIDERED SIGNED AND SEALED AND THE SIGNATURE MUST BE VERIFIED ON ANY ELECTRONIC COPIES.

Drawn: SWC
Checked: RDP
Approved: JAK
Date: 08/10/2019
Project #: 5592

THE ROBERT
FT. MYERS, FL

LEGEND, SCHEDULES AND DETAILS - FIRE PROTECTION

FP0.01

© 2016. These documents and their contents are the confidential and proprietary information of FUGLEBERG KOCH - A20062003, and are issued only for the specific project noted on these drawings. Any reproduction, whether in whole or in part, without the expressed written consent of FUGLEBERG KOCH, is prohibited by law.

PLOTTED: 6/4/2020 10:24:51 AM



PLOTTED: 6/4/2020
10:25:11 AM

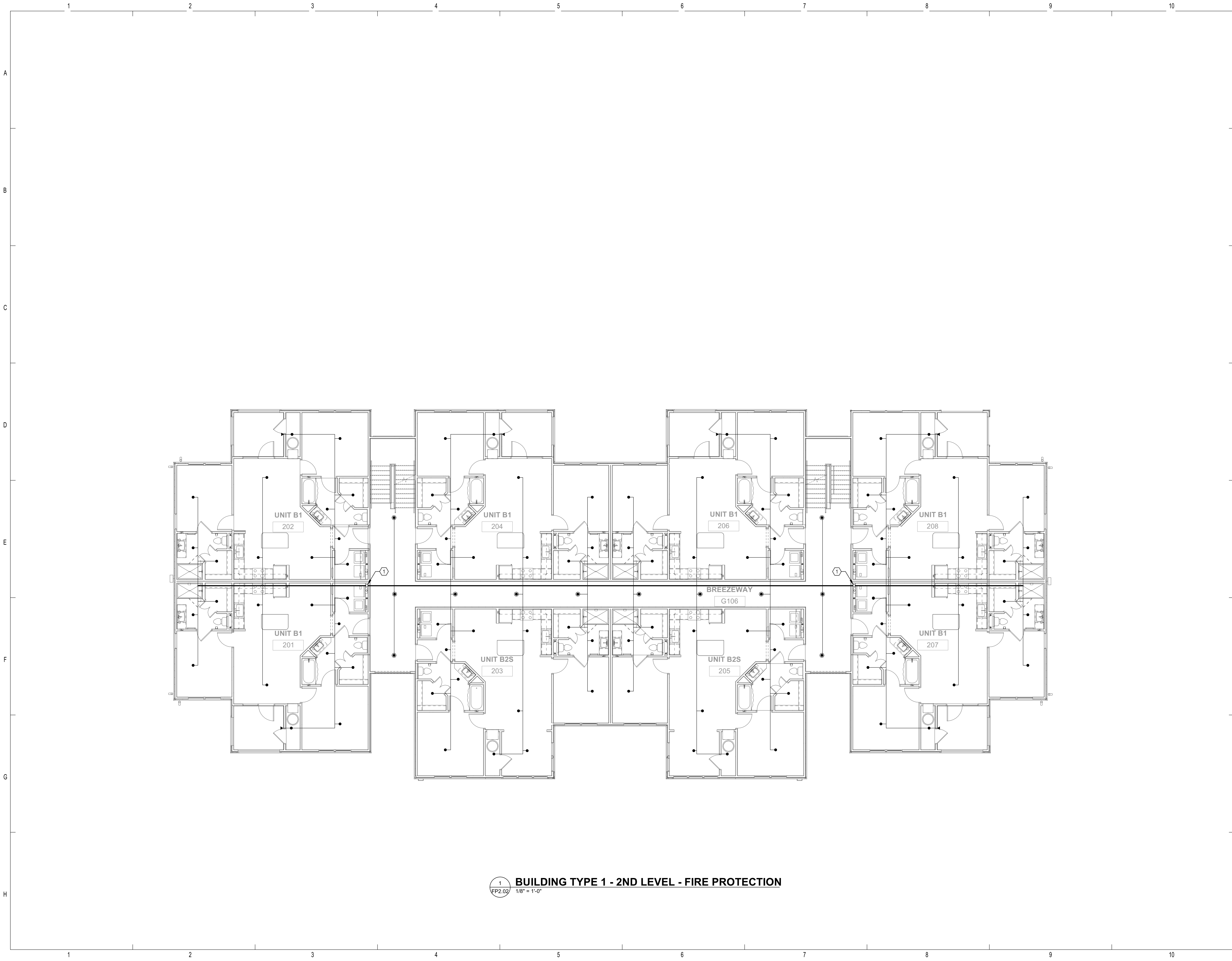

1
FP2.02
BUILDING TYPE 1 - 2ND LEVEL - FIRE PROTECTION
1/8" = 1'-0"

REFERENCE 1

1 FIRE LINE UP FROM BE

CITY OF FORT MYERS

THIS PLAN REVIEWED FOR SUBSTANTIAL CODE COMPLIANCE WITH ALL APPLICABLE CODES.

DATE APPROVED: 05/17/20

PERMIT NUMBER: BL2020-00848

PROPERTY ADDRESS: 3815 OLD BERRY POINT

JOB DESCRIPTION: New construction of a 3 story apartment building that includes 77 units of 44 units and 6 direct entry direct entry garage units. The building prov



PERMIT REVIEW STAMP

ISSUE HISTORY

| No. | Date | Description |
|-----|----------|--------------------|
| 1 | 11/22/19 | SCHEMATIC DESIGN |
| 2 | 12/06/19 | DESIGN DEVELOPMENT |
| 3 | 02/28/20 | PERMIT REVIEW SET |

REVISION HISTORY

| No. | Date | Description |
|-----|----------|--------------------------|
| 1 | 05/06/20 | PERMIT COMMENT RESPONSES |

FUGLEBERG KOCH
PLLC

2555 Temple Trail, Winter Park, FL 32789 (407) 629-0595
www.fuglebergkoch.com BR569

CONSULTANT
SALAS O'BRIEN
| expect a difference |
2001 Quasquare Boulevard, Suite 100
Orlando, Florida 32817
CERT. OF AUTH. NO. 4106
DAVID A. WALKERSON, P.E. 43167
BRYCE J. CARTER, P.E. 30389
JEFF A. KIRKMAN, P.E. 68519
CLAUDE S. LEVINE, P.E. 77079

THIS ITEM HAS BEEN ELECTRONICALLY SIGNED AND SEALED BY JEFFREY A. KIRKMAN, PE ON DATE 08/10/2019.
PRINTED COPIES OF THIS DOCUMENT ARE NOT CONSIDERED SIGNED AND SEALED AND THE SIGNATURE MUST BE VERIFIED ON ANY ELECTRONIC COPIES.

THE ROBERT

FT. MYERS, FL

Drawn: SWC

Checked: RDP

Approval: JAK

Date: 08/10/2019

Project #: 5592

BUILDING TYPE 1 - 2ND
LEVEL - FIRE PROTECTION

FP2.02



1 FIRE LINE UP FROM B



PERMIT REVIEW STAFF

| No. | Date | Description |
|-----|----------|--------------------|
| 1 | 11/22/19 | SCHEMATIC DESIGN |
| 2 | 12/06/19 | DESIGN DEVELOPMENT |
| 3 | 02/28/20 | PERMIT REVIEW SET |

| No. | Date | Description |
|-----|----------|--------------------|
| 1 | 05/06/20 | PERMIT COMMENT RES |

2555 Temple Trail, Winter Park, FL 32789 (407) 629-0593
www.fuglebergkoch.com BR569

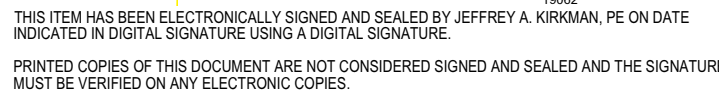

FT. MYERS, FL.

FP2.03

PLOTTED: 6/4/2020
10:25:49 AM



1 3" FIRE RISER. SEE DETAIL
2 FOR CONTINUATION,
3 FIRE LINE UP TO FLOOR

[illegible]

| REVISION HISTORY | | |
|------------------|----------|----------------------|
| No. | Date | Description |
| 1 | 05/06/20 | PERMIT COMMENT RESPO |

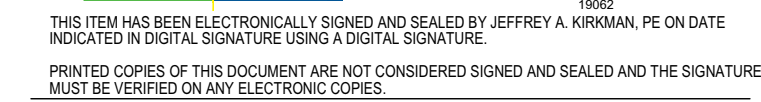
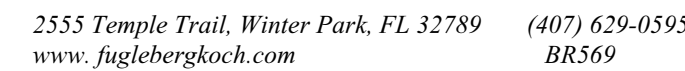

BUILDING TYPE 2 - GROUND LEVEL - FIRE PROTECTION

PLOTTED: 6/4/2020
10:26:08 AM

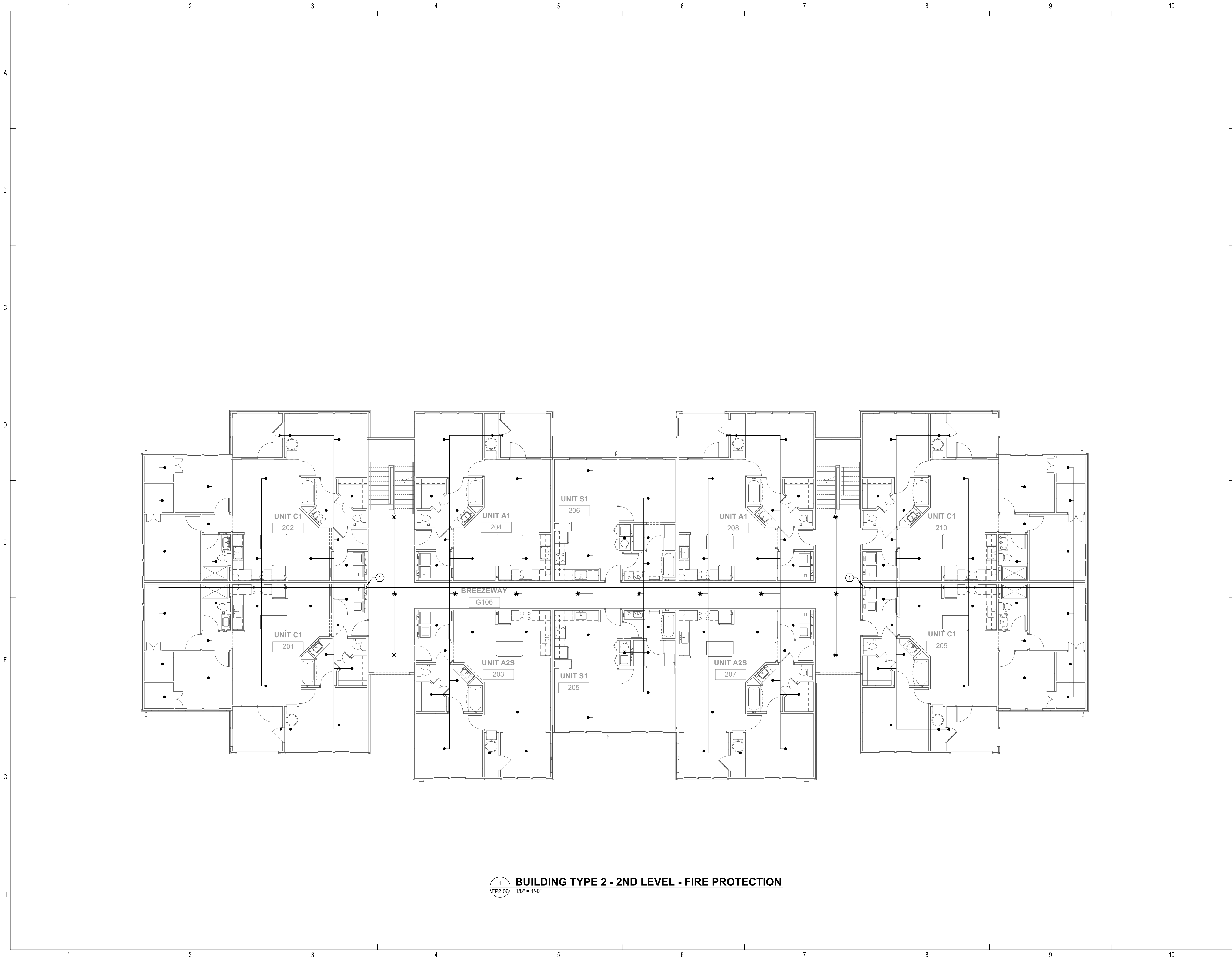

BUILDING TYPE 2 - 2ND LEVEL - FIRE PROTECTION
1/8" = 1'-0"

REFERENCE 1
FIRE LINE UP FROM BE

CITY OF FORT MYERS
THIS PLAN REVIEWED FOR SUBSTANTIAL CODE
COMPLIANCE WITH ALL APPLICABLE CODES.
DATE APPROVED: 06/17/20
PERMIT NUMBER: BL2020-00848
PROPERTY ADDRESS: 3815 OLD BERRY POINT
JOB DESCRIPTION: New construction of a 3 story
apartment building that
includes 77 units of 44 units
and 6 direct entry direct entry
garage units. The building
pro

1

PERMIT REVIEW STAMP

ISSUE HISTORY

| No. | Date | Description |
|-----|----------|--------------------|
| 1 | 11/22/19 | SCHEMATIC DESIGN |
| 2 | 12/06/19 | DESIGN DEVELOPMENT |
| 3 | 02/28/20 | PERMIT REVIEW SET |

REVISION HISTORY

| No. | Date | Description |
|-----|----------|--------------------------|
| 1 | 05/06/20 | PERMIT COMMENT RESPONSES |

FUGLEBERG KOCH
PLLC
2555 Temple Trail, Winter Park, FL 32789 (407) 629-0595
www.fuglebergkoch.com BR569

CONSULTANT
SALAS O'BRIEN
| expect a difference |
2001 Quadsquare Boulevard, Suite 100
Orlando, Florida 32817
CERT. OF AUTH. NO. 4106
DARYL A. WALKERSON, P.E. 43167
BRYCE J. CARTER, P.E. 30389
JEFF A. KIRKMAN, P.E. 68519
CLAUDE S. COVIE, P.E. 77079
THIS ITEM HAS BEEN ELECTRONICALLY SIGNED AND SEALED BY JEFFREY A. KIRKMAN, PE ON DATE
INDICATED IN DIGITAL SIGNATURE USING A DIGITAL SIGNATURE.
PRINTED COPIES OF THIS DOCUMENT ARE NOT CONSIDERED SIGNED AND SEALED AND THE SIGNATURE
MUST BE VERIFIED ON ANY ELECTRONIC COPIES.

THE ROBERT
FT. MYERS, FL

Drawn: SWC
Checked: RDP
Approval: JAK
Date: 08/10/2019
Project #: 5592

**BUILDING TYPE 2 - 2ND
LEVEL - FIRE PROTECTION**

FP2.06

© 2020 These documents and their contents are the property of FUGLEBERG KOCH - 430627023 and are issued only for the specific project noted on these drawings. Any reproduction, without, or modification of these documents without the consent of Fugleberg Koch is prohibited by law.



1 FIRE LINE UP FROM BE



ISSUE HISTORY

REVISION HISTORY

[illegible]

Salas O'Brien
[expect a difference]

3551 Quadrangle Boulevard, Suite 100
Orlando, Florida 32817
(407) 205-0400

CERT. OF AUTH. NO. 6198

■ GARY A. WILKERSON, P.E. 45167
 ■ WYLE J. CARTER, P.E. 62090
 ■ JEFF A. KROMAN, P.E. 69629
 ■ ADAM S. LEVINE, P.E. 77010

THIS ITEM HAS BEEN ELECTRONICALLY SIGNED AND SEALED BY JEFFREY A. KIRKMAN, PE ON DATE INDICATED IN DIGITAL SIGNATURE USING A DIGITAL SIGNATURE.

PRINTED COPIES OF THIS DOCUMENT ARE NOT CONSIDERED SIGNED AND SEALED AND THE SIGNATURE MUST BE VERIFIED ON ANY ELECTRONIC COPIES.

BUILDING TYPE 2 - 3RD LEVEL - FIRE PROTECTION

FP2.07

PLOTTED: 6/4/2020
10:26:47 AM

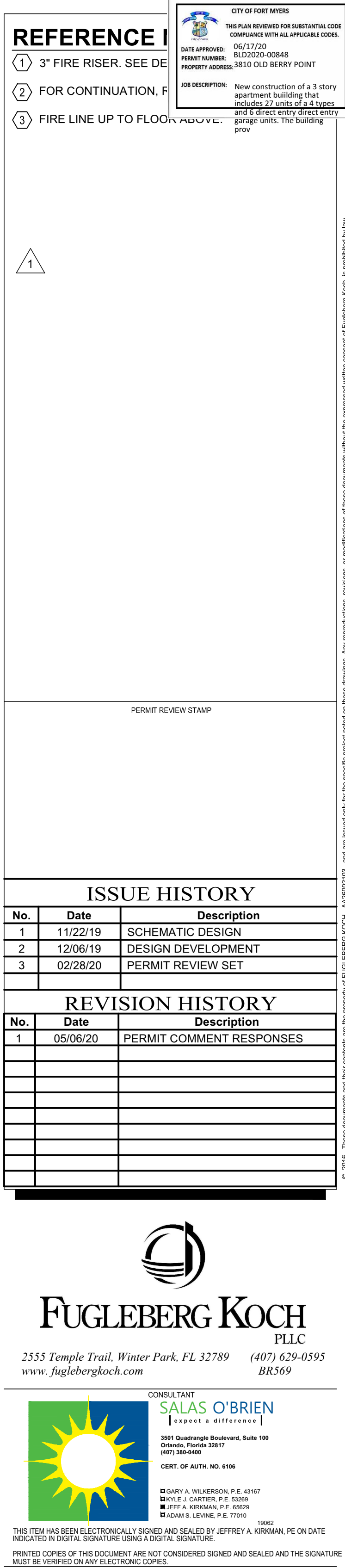

| | | |
|---|-----------|------------|
| <h1>THE ROBERT</h1> <p><i>FT. MYERS, FL</i></p> | Drawn: | SWC |
| | Checked: | RDP |
| | Approved: | JAK |
| | Date: | 09/10/2019 |
| Project #: | | 5552 |

BUILDING TYPE 3 - GROUND LEVEL - FIRE PROTECTION

FP2.09

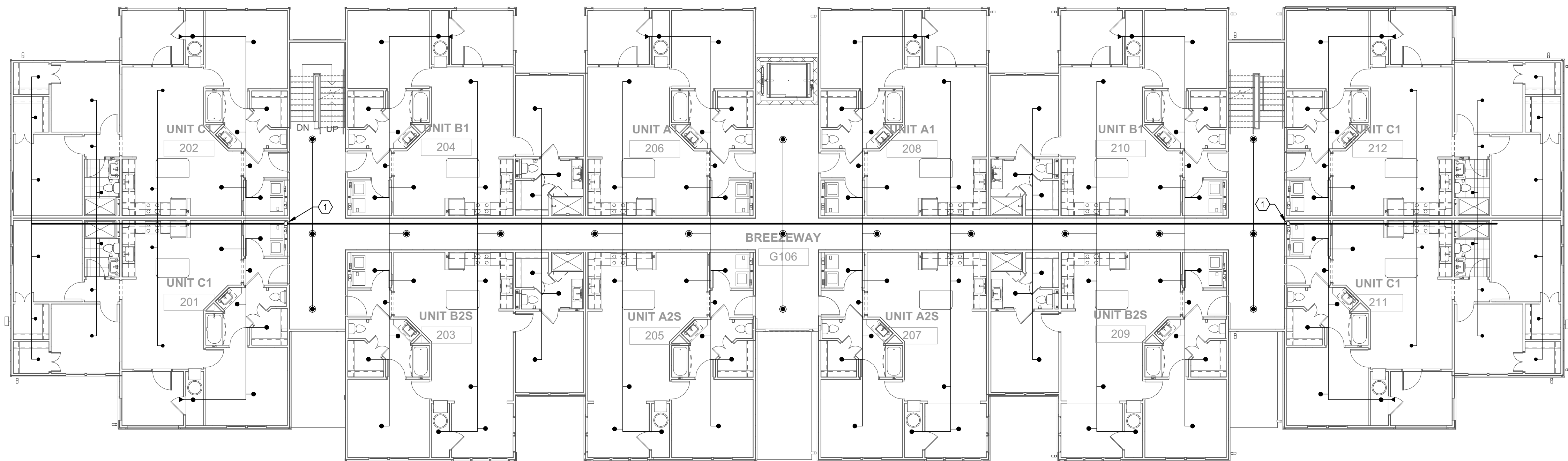

1 BUILDING TYPE 3 - 2ND LEVEL - FIRE PROTECTION

CITY OF FORT MYERS

 THIS PLAN REVIEWED FOR SUBSTANTIAL CODE COMPLIANCE WITH ALL APPLICABLE CODES.

DATE APPROVED: 06/17/20
PERMIT NUMBER: BLD2020-00848
PROPERTY ADDRESS: 2810 OLD BERRY POINT

JOB DESCRIPTION:
New construction of a 3 story apartment building that includes 27 units of a 4 types, and 6 direct entry direct entry garage units. The building prov

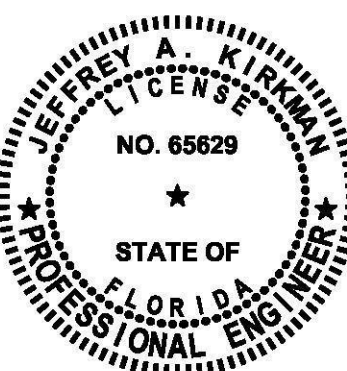

JEFFREY A. KIRKMAN
STATE OF FLORIDA
PROFESSIONAL ENGINEER
LICENSE NO. 65629

Digitally signed by Jeffrey A Kirkman
Date: 2020.06.04 10:36:56-04'00'

PERMIT REVIEW STAMP

| ISSUE HISTORY | | |
|---------------|----------|--------------------|
| No. | Date | Description |
| 1 | 11/22/19 | SCHEMATIC DESIGN |
| 2 | 12/06/19 | DESIGN DEVELOPMENT |
| 3 | 02/28/20 | PERMIT REVIEW SET |

[illegible]

FUGLEBERG KOCH
PLLC

2555 Temple Trail, Winter Park, FL 32789 (407) 629-0595
www.fuglebergkoch.com BR569



THIS ITEM HAS BEEN ELECTRONICALLY SIGNED AND SEALED BY JEFFREY A. KIRKMAN, PE ON DATE INDICATED IN DIGITAL SIGNATURE USING A DIGITAL SIGNATURE.

PRINTED COPIES OF THIS DOCUMENT ARE NOT CONSIDERED SIGNED AND SEALED AND THE SIGNATURE MUST BE VERIFIED ON ANY ELECTRONIC COPIES.

| | | |
|---|------------|------------|
| <h1>THE ROBERT</h1> <p><i>FT. MYERS, FL</i></p> | Drawn: | SWC |
| | Checked: | RDP |
| | Approval: | JAK |
| | Date: | 09/10/2019 |
| | Project #: | 5592 |

BUILDING TYPE 3 - 2ND LEVEL - FIRE PROTECTION

FP2.10

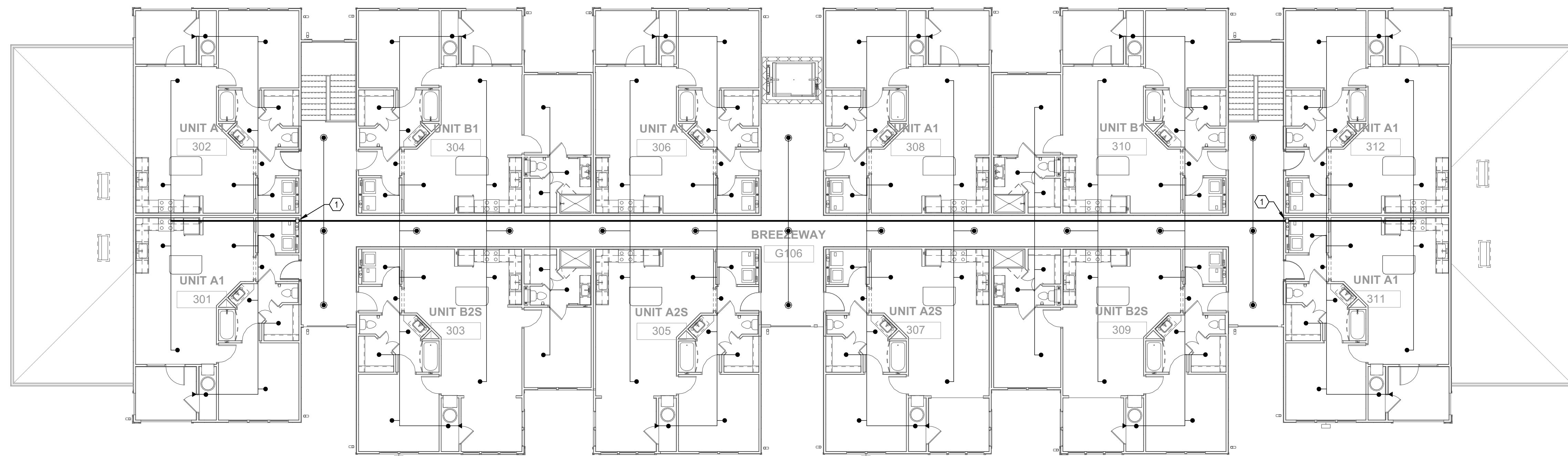

1 **BUILDING TYPE 3 - 3RD LEVEL - FIRE PROTECTION**

CITY OF FORT MYERS

 THIS PLAN REVIEWED FOR SUBSTANTIAL CODE COMPLIANCE WITH ALL APPLICABLE CODES.

DATE APPROVED: 06/17/20
PERMIT NUMBER: BLD2020-00848
PROPERTY ADDRESS: 2810 OLD BERRY POINT

JOB DESCRIPTION:
New construction of a 3 story apartment building that includes 27 units of a 4 types, and 6 direct entry direct entry garage units. The building prov

| ISSUE HISTORY | | |
|---------------|----------|--------------------|
| No. | Date | Description |
| 1 | 11/22/19 | SCHEMATIC DESIGN |
| 2 | 12/06/19 | DESIGN DEVELOPMENT |
| 3 | 02/28/20 | PERMIT REVIEW SET |

[illegible]

FUGLEBERG KOCH
PLLC

2555 Temple Trail, Winter Park, FL 32789 (407) 629-0593
www.fuglebergkoch.com BR569

CONSULTANT



SALAS O'BRIEN
| expect a difference |

3501 Quadrangle Boulevard, Suite 100
Orlando, Florida 32817
(407) 200-2400

CERT. OF AUTH. NO. 6106

■ GARY A. WILKERSON, P.E. 45167
■ KYLE J. CARTIER, P.E. 52020
■ JEFF A. KROMAN, P.E. 69629
■ ADAM S. LEVINE, P.E. 77010

THIS ITEM HAS BEEN ELECTRONICALLY SIGNED AND SEALED BY JEFFREY A. KIRKMAN, PE ON DATE
INDICATED IN DIGITAL SIGNATURE USING A DIGITAL SIGNATURE.

PRINTED COPIES OF THIS DOCUMENT ARE NOT CONSIDERED SIGNED AND SEALED AND THE SIGNATURE
MUST BE VERIFIED ON ANY ELECTRONIC COPIES.

THE ROBERT

FT. MYERS, FL.

BUILDING TYPE 3 - 3RD LEVEL - FIRE PROTECTION

FP2.11