

1 RISER DETAIL
FP0.01 NOT TO SCALE

61G15-32.004 DESIGN OF WATER BASED FIRE PROTECTION SYSTEMS.

(1) WATER BASED FIRE PROTECTION SYSTEMS INCLUDE, BUT ARE NOT LIMITED TO, AUTOMATIC SPRINKLER SYSTEMS OF WET, DRY, FINE WATER SPRAY (MIST), MANUAL AND DELUGE VALVE CONTROLLED TYPES, PUMPING SYSTEMS, STANDPIPES, FIRE WATER MAINS AND DEDICATED FIRE PROTECTION WATER SOURCES.

(2) TO ENSURE MINIMUM DESIGN QUALITY IN FIRE PROTECTION SYSTEM ENGINEERING DOCUMENTS, SAID DOCUMENTS SHALL INCLUDE AS A MINIMUM THE FOLLOWING INFORMATION WHEN APPLICABLE:

(A) THE POINT OF SERVICE FOR THE FIRE PROTECTION WATER SUPPLY AS DEFINED BY SECTION 633.021(18), F.S.

THE POINT OF SERVICE AND FIRE DEPARTMENT CONNECTION IS LOCATED ON CIVIL DRAWINGS

(B) APPLICABLE NFPA STANDARD TO BE APPLIED, OR IN THE CASE WHERE NO SUCH STANDARD EXISTS, THE ENGINEERING STUDY, JUDGEMENTS, AND/OR PERFORMANCE BASED ANALYSIS AND CONCLUSIONS.

NFPA 13R, 2013 EDITION, INSTALLATION OF SPRINKLER SYSTEMS
NFPA 24, 2010 EDITION, INSTALLATION OF FIRE SERVICE MAINS.

(C) CLASSIFICATION OF HAZARD OCCUPANCY FOR EACH ROOM OR AREA.

SYSTEM DESIGNED PER NFPA 13R USING A 0.05 GPM/SQ FT FOR ALL DWELLING UNITS (RESIDENTIAL OCCUPANCY) USING RESIDENTIAL SPRINKLERS.

(D) DESIGN APPROACH, WHICH INCLUDES SYSTEM TYPE, DENSITIES, DEVICE TEMPERATURE RATING, AND SPACING FOR EACH SEPARATE HAZARD OCCUPANCY.

SPRINKLER SYSTEM TO EXTEND INTO ALL AREAS IN ACCORDANCE WITH NFPA 13R LISTED AND APPROVED UPRIGHT SPRINKLER HEADS TO BE PROVIDED. SEE FIRE PROTECTION SCHEDULE ON THIS SHEET. HEADS SHALL BE RATED AT 155 DEGREES F.

(E) CHARACTERISTICS OF WATER SUPPLY TO BE USED, SUCH AS MAIN SIZE AND LOCATION, WHETHER IT IS DEAD-END OR CIRCULATING; AND IF DEAD-END, THE DISTANCE TO THE NEAREST CIRCULATING MAIN, AS WELL AS ITS MINIMUM DURATION AND RELIABILITY FOR THE MOST HYDRAULICALLY DEMANDING DESIGN AREA

THE WATER SUPPLY FOR THIS SPRINKLER SYSTEM IS PROVIDED BY A 10 INCH PRIVATELY OWNED WATER MAIN. THE DURATION FOR THE MOST REMOTE HYDRAULICALLY DEMANDING AREA IS 100 G.P.M. FOR 60 MINUTES.

(F) WHEN PRIVATE OR PUBLIC WATER SUPPLIES ARE USED, THE FLOW TEST DATA INCLUDING TIME AND DATE OF TEST, WHO CONDUCTED THE TEST OR SUPPLIED INFORMATION, TEST ELEVATION, STATIC GAUGE PRESSURE AT NO FLOW, FLOW RATE WITH RESIDUAL GAUGE PRESSURE, HYDRANT BUTT COEFFICIENT, AND LOCATION OF THE TEST IN RELATION TO THE HYDRAULIC POINT OF SERVICE.

PROVIDED BY SPRINKLER CONTRACTOR.

(G) VALVING AND ALARM REQUIREMENTS TO MINIMIZE POTENTIAL FOR IMPAIRMENTS AND UNRECOGNIZED FLOW OF WATER.

THE FIRE SPRINKLER RISER FOR THE BUILDING WILL BE EQUIPPED WITH A WATER FLOW SWITCH WITH A LOCAL ALARM AND OFF-SITE MONITORING.

(H) MICROBIAL INDUCED CORROSION (MIC). THE ENGINEER OF RECORD SHALL MAKE REASONABLE EFFORTS TO IDENTIFY WATER SUPPLIES THAT COULD LEAD TO MICROBIAL INDUCED CORROSION (MIC). SUCH EFFORTS MAY CONSIST OF DISCUSSIONS WITH LOCAL WATER PURVEYOR AND/OR FIRE OFFICIAL, FAMILIARITY WITH CONDITIONS IN THE LOCAL AREA, OR LABORATORY TESTING OF WATER SUPPLIES. WHEN CONDITION ARE FOUND THAT MAY RESULT IN MIC CONTAMINATION OF THE FIRE PROTECTION PIPING, THE ENGINEER SHALL DESIGN CORRECTIVE MEASURES.

BASED ON DISCUSSIONS WITH THE LOCAL WATER UTILITIES, THERE HAVE BEEN NO INDICATIONS OF M.I.C.

(I) BACKFLOW PREVENTION AND METERING SPECIFICATIONS AND DETAILS TO MEET LOCAL WATER PREVENTER REQUIREMENTS INCLUDING MAXIMUM ALLOWABLE PRESSURE DROP.

THE BACKFLOW PREVENTION DEVICE ASSEMBLY AND METERING EQUIPMENT WILL MEET THE REQUIREMENTS OF THE LOCAL WATER PURVEYOR. MAX. PRESSURE DROP 8 PSI.

(J) QUALITY AND PERFORMANCE SPECIFICATIONS OF ALL YARD AND INTERIOR FIRE PROTECTION COMPONENTS.

ALL NEW YARD AND INTERIOR FIRE PROTECTION EQUIPMENT SHALL BE U.L. LISTED AND F.M. APPROVED.

(3) CONTRACTOR SUBMITTALS WHICH DEVIATE FROM THE ABOVE MINIMUM DESIGN PARAMETERS SHALL BE CONSIDERED MATERIAL DEVIATIONS AND REQUIRE SUPPLEMENTAL ENGINEERING APPROVAL AND DOCUMENTATION.

THE SUCCESSFUL FLORIDA LICENSED FIRE PROTECTION CONTRACTOR SHALL SUBMIT FIRE PROTECTION SHOP DRAWINGS AS NEEDED TO FULFILL THE REQUIREMENTS FOR A FIRE SPRINKLER PERMIT.

(4) IN THE EVENT THE ENGINEER OF RECORD PROVIDES MORE INFORMATION AND DIRECTION THAN IS ESTABLISHED ABOVE, HE OR SHE SHALL BE HELD RESPONSIBLE FOR THE TECHNICAL ACCURACY OF THE WORK IN ACCORDANCE WITH APPLICABLE CODES, STANDARDS, AND SOUND ENGINEERING PRINCIPLES.

(5) THE UNDERGROUND AND INSIDE PIPING SHALL BE HYDROSTATICALLY TESTED AT 200 PSI FOR 2 HOURS PER 16.2.1

(6) THE FIRE PROTECTION CONTRACTOR SHALL COMPLY WITH CHAPTER 10 SECTION 10.2.

A. ALL UNDERGROUND PIPING FROM THE WATER MAIN TO THE RISER SHALL BE COMPLETELY FLUSHED. THE FLUSHING SHALL CONTINUE FOR SUFFICIENT TIME TO ENSURE CLEANING.

B. THE MINIMUM FLOW SHALL NOT BE LESS THAN: HYDRAULICALLY CALCULATED DEMAND INCLUDING HOSE STREAM ALLOWANCE, FLOW RATE AVAILABLE UNDER FIRE CONDITIONS.

(7) ALL PIPING AND APPURTENANCES SHALL BE PRESSURE TESTED AT 200 PSI OR 50 PSI IN EXCESS OF SYSTEM PRESSURE, WHICH EVER IS GREATER, FOR A MINIMUM OF 2 HOURS WITH OUT ANY LOSSES.

FIRE PROTECTION SCHEDULE							
SYMBOL	TEMP. RATING	TYPE	ORIFICE SIZE	K-FACTOR	FINISH	ACCESSORIES	SELECTION
●	155°F	SEMI-RECESSED PENDENT	1/2"	4.9	WHITE	WHITE ESCUTCHEON	TYCO RAPID RESPONSE SERIES LFI
●	155°F	SEMI-RECESSED PENDENT	1/2"	5.6	WHITE	WHITE ESCUTCHEON	TYCO RAPID RESPONSE SERIES LFI
◀	155°F	HORIZONTAL SIDEWALL	1/2"	4.2	CHROME	-	TYCO RAPID RESPONSE SERIES LFI

HANGER SPACING FOR CPVC PIPING	
NOMINAL PIPE SIZE (INCHES)	MAX. SPACING (FEET)
3/4"	5-1/2
1"	6
1-1/4"	6-1/2
1-1/2"	7
2"	8
2-1/2"	9
3"	10

FIRE PROTECTION SYMBOL LEGEND	
	FIRE PROTECTION SUPPLY PIPING
	SOLENOID VALVE WITH TAMPER SWITCH
	BUTTERFLY VALVE WITH TAMPER SWITCH
	FLOW SWITCH
	FIRE DEPARTMENT CONNECTION PIPING
	PIPE HANGER
	POST INDICATING VALVE
	FIRE DEPT. CONNECTION

ABBREVIATIONS	
CONT.	CONTINUATION
ETR	EXISTING TO REMAIN
N	NEW HEAD
F	FIRE
FH	FIRE HYDRANT
FDC	FIRE DEPARTMENT CONNECTION
FS	FLOW SWITCH
GPM	GALLONS PER MINUTE
PSI	POUNDS PER SQUARE INCH (WATER PRESSURE)
PIV	POST INDICATING VALVE
R	RELOCATE HEAD
TS	TAMPER SWITCH

FIRE PROTECTION SPRINKLER DESIGN

- THESE DRAWINGS ARE INTENDED TO ILLUSTRATE THE DESIGN INTENT AND AID IN THE COORDINATION OF ELEMENTS OF A FIRE PROTECTION SPRINKLER DESIGN.
- THE DESIGN OF THE FIRE PROTECTION SPRINKLER SYSTEM SHALL BE PROVIDED IN ACCORDANCE WITH THE REQUIREMENTS OF THE AUTHORITY HAVING JURISDICTION AND THE APPLICABLE STANDARDS FROM THE NATIONAL FIRE PROTECTION ASSOCIATION (NFPA).
- THE FIRE PROTECTION SPRINKLER DESIGN SHALL BE COORDINATED WITH OTHER ASPECTS OF THE BUILDING DESIGN INCLUDING, BUT NOT LIMITED TO, FIRE ALARM, ELECTRICAL POWER AND LIGHTING, REFLECTED CEILING, DUCTWORK, PLUMBING AND THE BUILDING STRUCTURAL SYSTEM.
- THE FIRE PROTECTION SPRINKLER DESIGN DRAWINGS SHALL BE SUBMITTED FOR COORDINATION PRIOR TO INSTALLATION OF THE SYSTEM. INSTALLATION WITHOUT COORDINATION WILL BE AT THE CONTRACTOR'S RISK AND REWORK OF THE SYSTEM SHALL BE PROVIDED WITHOUT ADDITIONAL COST.
- APPLICABLE FIRE CODES. FLORIDA FIRE PREVENTION CODE FIFTH EDITION, BASED ON NFPA 1, FIRE CODE, 2013 EDITION AND NFPA 101, LIFE SAFETY CODE, 2013 EDITION.
- A STATE OF FLORIDA LICENSED FIRE SPRINKLER CONTRACTOR SHALL PROVIDE THE LAYOUT DOCUMENTS.

FIRE HYDRANT FLOW TEST DATA	
TEST DATE:	6/17/16
TEST BY:	FORT MYERS FIRE DEPARTMENT
THE FLOW HYDRANT:	#314425H045
LOCATION:	FORT MYERS FLORIDA SHOEMAKER LANE
STATIC PRESSURE:	56 PSI
RESIDUAL PRESSURE:	48 PSI
FLOW:	2226 GPM
PITOT SIZE:	2-1/2"

GENERAL NOTES

- A CURRENT FIRE HYDRANT FLOW TEST HAS BEEN REQUESTED TO BE PERFORMED BY THE FORT MYERS FIRE DEPARTMENT AND THE RESULTS WHEN RECEIVED WILL BE PROVIDED.

GENERAL NOTES

- ALL WORK & MATERIAL SHALL BE DONE IN ACCORDANCE WITH NFPA 13R AND THE LOCAL AUTHORITY.
- ALL PIPE AND FITTINGS TO BR CPVC, UNLESS NOTED OTHERWISE EXCEPT FOR THE BLDG. RISER WHICH SHALL BE SCHEDULE 40 GALVANIZED STEEL
- ALL RESIDENTIAL SPRINKLER HEAD SPACING TO BE IN ACCORDANCE WITH THE MANUFACTURER'S LISTING.
- ALL FIREWALL PENETRATIONS TO BE SEALED IN ACCORDANCE WITH THEIR RATING.
- PROVIDE SIGN ON DOOR INDICATING "FIRE RISER INSIDE".
- ALL FIRE SPRINKLER WORK, INCLUDING CHANGES, ADDITIONS, RELOCATIONS, IMPROVEMENTS, AND/OR MODIFICATIONS TO THE FIRE SPRINKLER SYSTEM, MUST BE DONE PER NFPA-13 2013 EDITION, BY A LICENSED FIRE SPRINKLER CONTRACTOR WITH SEPARATE PERMIT AND PLANS.

DESIGN CRITERIA

- THE NUMBER OF DESIGN SPRINKLERS SHALL INCLUDE ALL SPRINKLERS WITHIN A COMPARTMENT UP TO A MINIMUM OF FOUR SPRINKLERS UNDER A FLAT, SMOOTH, HORIZONTAL CEILING, ANY LINTEL WITH 8" MINIMUM WILL DIVIDE AN AREA INTO TWO COMPARTMENTS.

ISSUE HISTORY		
No.	Date	Description
1	11/22/19	SCHEMATIC DESIGN
2	12/06/19	DESIGN DEVELOPMENT
3	02/28/20	PERMIT REVIEW SET

REVISION HISTORY		
No.	Date	Description
2	06/03/20	PERMIT COMMENT RESPONSES

FUGLEBERG KOCH
PLLC

2555 Temple Trail, Winter Park, FL 32789 (407) 629-0595
www.fuglebergkoch.com BR569

CONSULTANT
SALAS O'BRIEN
[expect a difference]

3901 Quailridge Boulevard, Suite 100
Orlando, Florida 32817
(407) 380-6800
CERT. OF ARCH. NO. 6166

GARY A. WILKINSON, P.E. 41547
DANIEL J. CARTER, P.E. 63839
JEFF A. KORSMAN, P.E. 66029
MICHAEL S. LEVINE, P.E. 77030

THIS ITEM HAS BEEN ELECTRONICALLY SIGNED AND SEALED BY: JEFFREY A. KORSMAN, PE ON DATE INDICATED IN DIGITAL SIGNATURE USING A DIGITAL SIGNATURE.
PRINTED COPIES OF THIS DOCUMENT ARE NOT CONSIDERED SIGNED AND SEALED AND THE SIGNATURE MUST BE VERIFIED ON ANY ELECTRONIC COPIES.

Drawn:	SWC
Checked:	RDP
Approval:	JAK
Date:	09/10/2019
Project #:	5592

THE ROBERT
FT. MYERS, FL

LEGEND, SCHEDULES AND DETAILS - FIRE PROTECTION

FP0.01

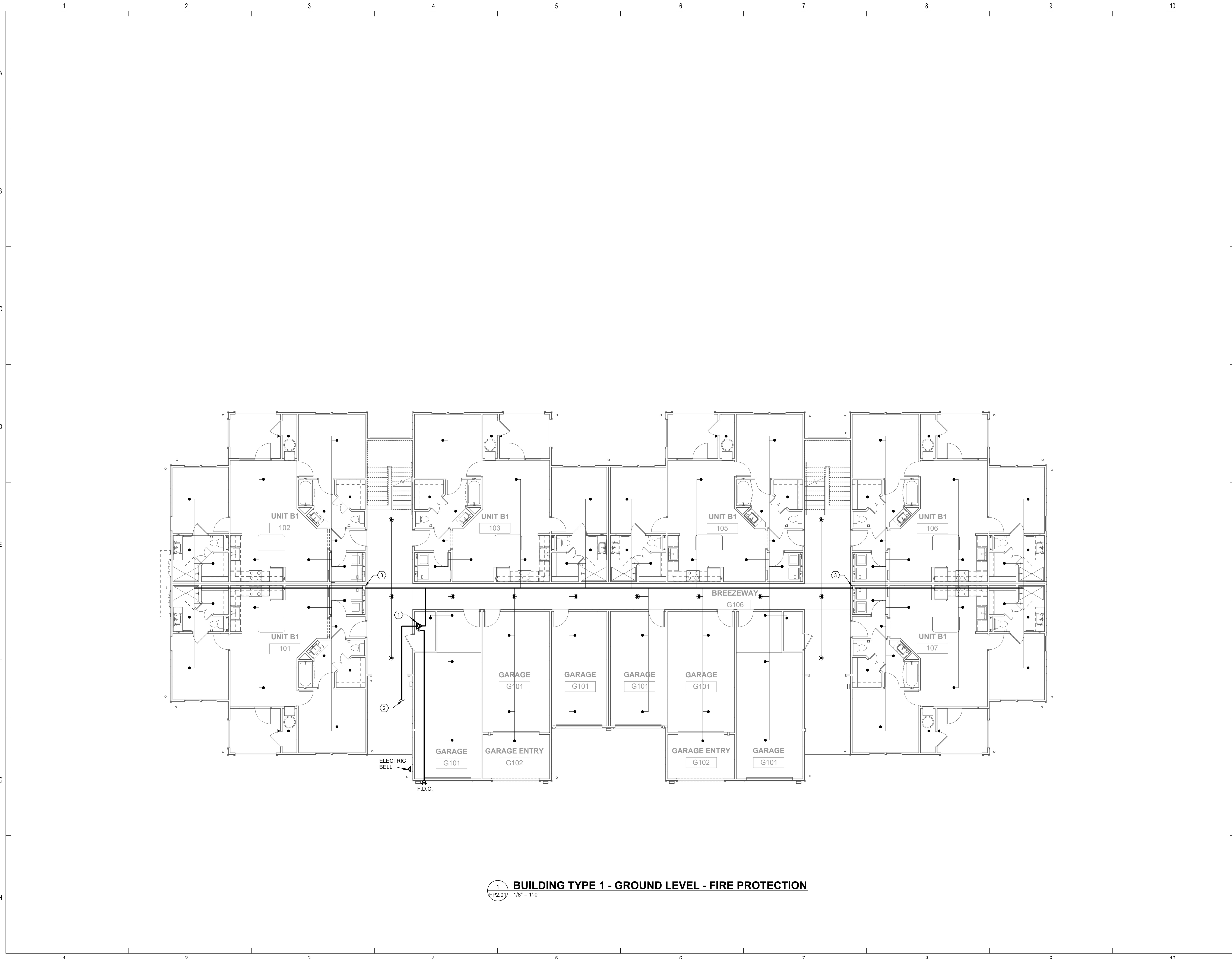

REFERENCE NOTES

- ① 3" FIRE RISER. SEE DETAIL.
- ② FOR CONTINUATION, REFER TO CIVIL DRAWINGS.
- ③ FIRE LINE UP TO FLOOR ABOVE.

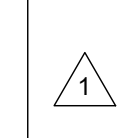

PERMIT REVIEW STAMP

ISSUE HISTORY

No.	Date	Description
1	11/22/19	SCHEMATIC DESIGN
2	12/06/19	DESIGN DEVELOPMENT
3	02/28/20	PERMIT REVIEW SET

REVISION HISTORY

No.	Date	Description
1	05/06/20	PERMIT COMMENT RESPONSES

FUGLEBERG KOCH
 PLLC
 2555 Temple Trail, Winter Park, FL 32789 (407) 629-0595
 www.fuglebergkoch.com BR569

SALAS O'BRIEN
 CONSULTANT
 [Expect a difference]
 3901 Quince Orchard Boulevard, Suite 100
 Gaithersburg, Florida 32817
 (407) 388-6800
 CERT. OF AUTH. NO. 6106

THIS ITEM HAS BEEN ELECTRONICALLY SIGNED AND SEALED BY: JEFFREY A. KORSMAN, PE ON DATE INDICATED IN DIGITAL SIGNATURE USING A DIGITAL SIGNATURE.
 PRINTED COPIES OF THIS DOCUMENT ARE NOT CONSIDERED SIGNED AND SEALED AND THE SIGNATURE MUST BE VERIFIED ON ANY ELECTRONIC COPIES.

Drawn:	SWC
Checked:	RDP
Approval:	JAK
Date:	09/10/2019
Project #:	5582

THE ROBERT
 FT. MYERS, FL

BUILDING TYPE 1 - GROUND LEVEL - FIRE PROTECTION

FP2.01

1 BUILDING TYPE 1 - GROUND LEVEL - FIRE PROTECTION
 FP2.01 1/8" = 1'-0"

© 2019 These documents and their contents are the property of FUGLEBERG KOCH - A20202101, and are issued only for the specific project noted on these drawings. Any reproduction, revision, or modification of these documents without the expressed written consent of Fugleberg Koch, is prohibited by law.

REFERENCE NOTES

- ① FIRE LINE UP FROM BELOW.



PERMIT REVIEW STAMP

ISSUE HISTORY

No.	Date	Description
1	11/22/19	SCHEMATIC DESIGN
2	12/06/19	DESIGN DEVELOPMENT
3	02/28/20	PERMIT REVIEW SET

REVISION HISTORY

No.	Date	Description
1	05/06/20	PERMIT COMMENT RESPONSES



FUGLEBERG KOCH
PLLC

2555 Temple Trail, Winter Park, FL 32789 (407) 629-0395
www.fuglebergkoch.com BR569

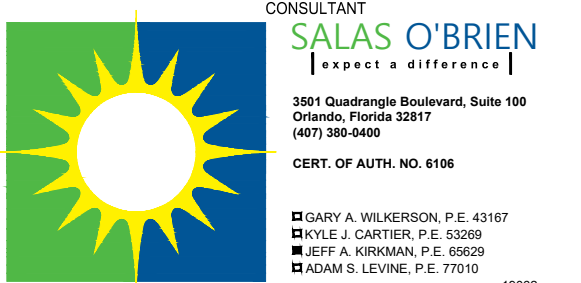

THIS ITEM HAS BEEN ELECTRONICALLY SIGNED AND SEALED BY JEFFREY A. KORSMAN, PE ON DATE INDICATED IN DIGITAL SIGNATURE USING A DIGITAL SIGNATURE.
PRINTED COPIES OF THIS DOCUMENT ARE NOT CONSIDERED SIGNED AND SEALED AND THE SIGNATURE MUST BE VERIFIED ON ANY ELECTRONIC COPIES.

THE ROBERT

FT. MYERS, FL

**BUILDING TYPE 1 - 2ND
LEVEL - FIRE PROTECTION**

FP2.02

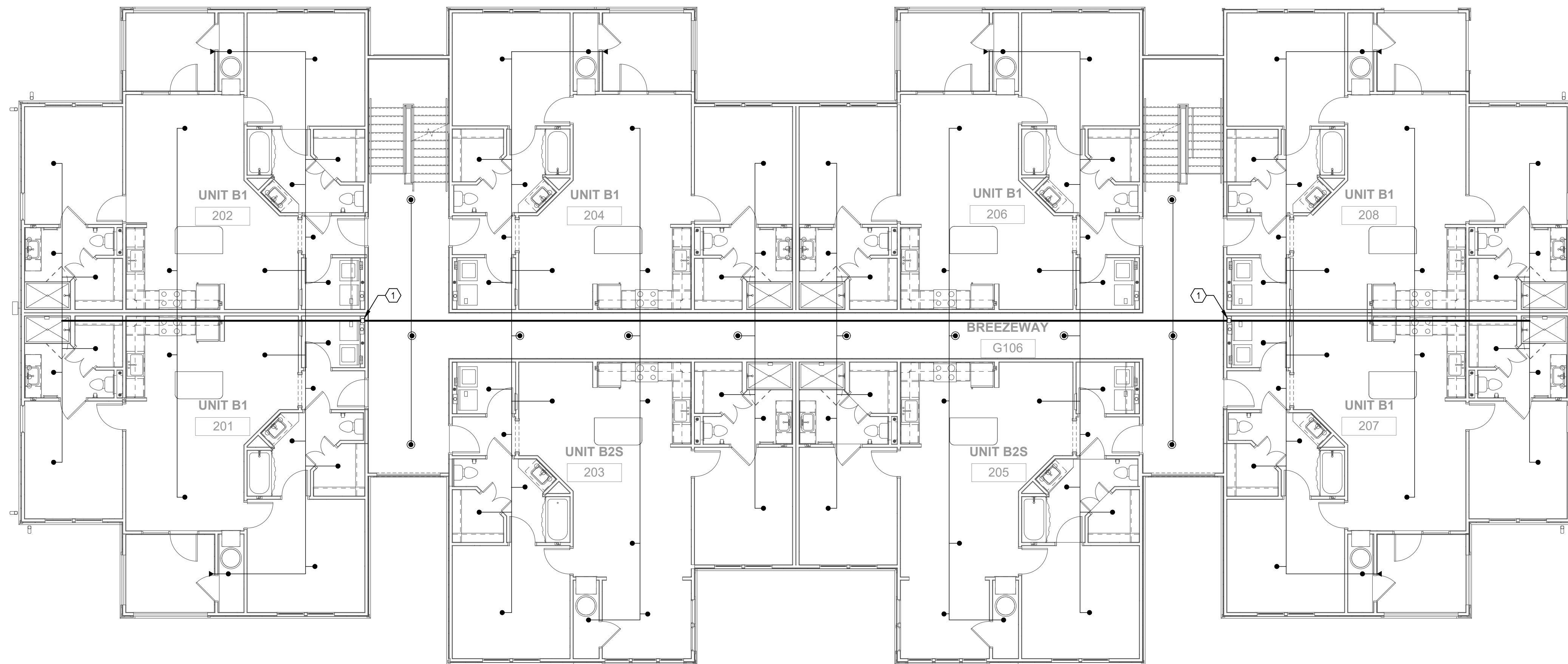

BUILDING TYPE 1 - 2ND LEVEL - FIRE PROTECTION

1
FP2.02
1/8" = 1'-0"

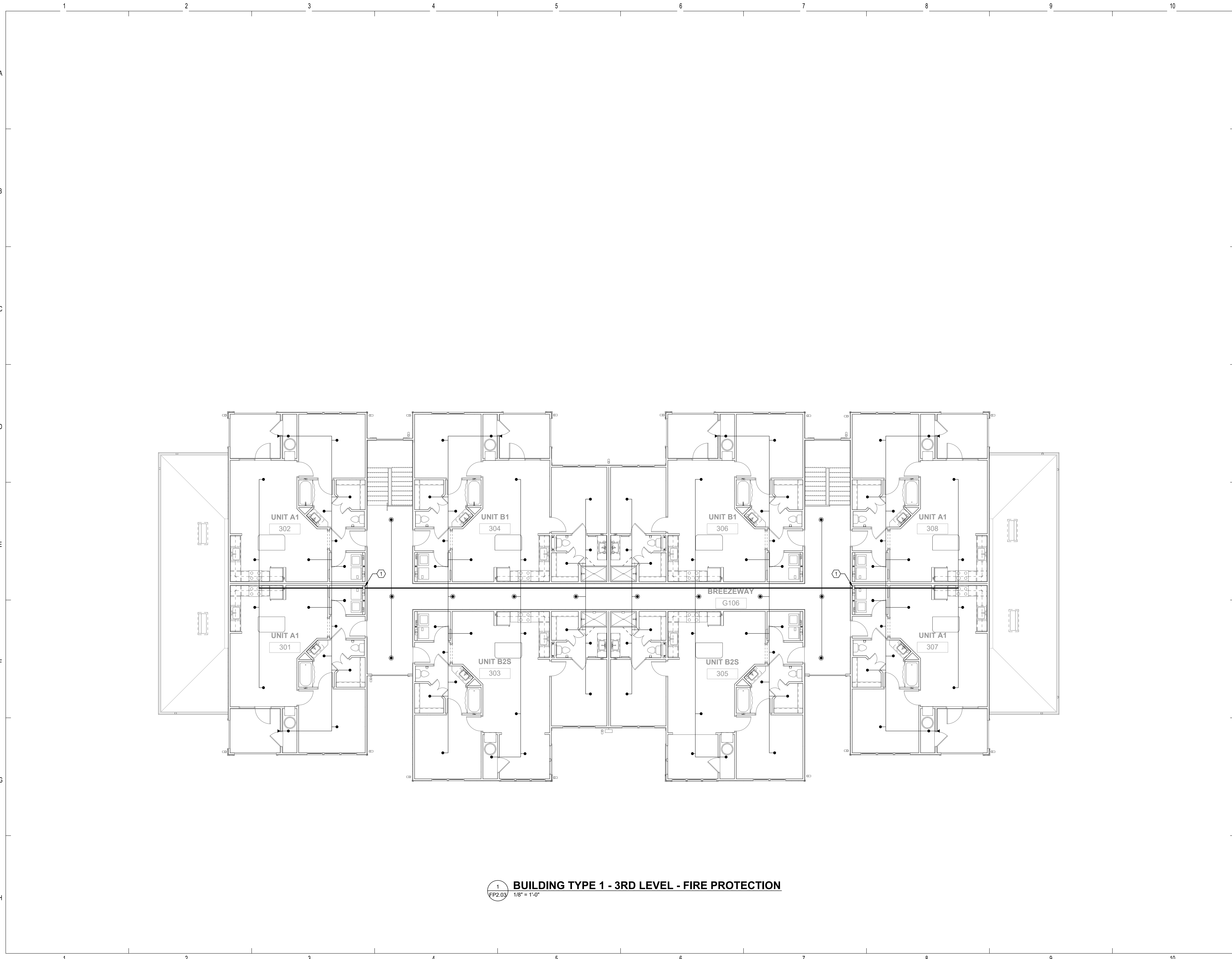

REFERENCE NOTES

- ① FIRE LINE UP FROM BELOW.

PERMIT REVIEW STAMP

ISSUE HISTORY

No.	Date	Description
1	11/22/19	SCHEMATIC DESIGN
2	12/06/19	DESIGN DEVELOPMENT
3	02/28/20	PERMIT REVIEW SET

REVISION HISTORY

No.	Date	Description
1	05/06/20	PERMIT COMMENT RESPONSES

FUGLEBERG KOCH
PLLC
2555 Temple Trail, Winter Park, FL 32789 (407) 629-0395
www.fuglebergkoch.com BR569

CONSULTANT
SALAS O'BRIEN
Expect a difference!
3901 Quince Orchard, Suite 100
Gaithersburg, MD 20878
(410) 386-6800
CENT. OF ARCH. NO. 6106
19062
■ GARY A. WILKINSON, P.E. 43167
■ MICHAEL J. CARTER, P.E. 53309
■ JEFF A. KIRKMAN, P.E. 69029
■ MICHAEL S. LEVINE, P.E. 77019

THIS ITEM HAS BEEN ELECTRONICALLY SIGNED AND SEALED BY: JEFFREY A. KIRKMAN, PE ON DATE INDICATED IN DIGITAL SIGNATURE USING A DIGITAL SIGNATURE.
PRINTED COPIES OF THIS DOCUMENT ARE NOT CONSIDERED SIGNED AND SEALED AND THE SIGNATURE MUST BE VERIFIED ON ANY ELECTRONIC COPIES.

Drawn:	SWC
Checked:	RDP
Approval:	JAK
Date:	09/10/2019
Project #:	5582

THE ROBERT
FT. MYERS, FL

BUILDING TYPE 1 - 3RD LEVEL - FIRE PROTECTION
FP2.03

BUILDING TYPE 1 - 3RD LEVEL - FIRE PROTECTION
1/8" = 1'-0"

© 2019 These documents and their contents are the property of FUGLEBERG KOCH - A20202103, and are issued only for the specific project noted on these drawings. Any reproduction, revision, or modification of these documents without the expressed written consent of Fugleberg Koch, is prohibited by law.

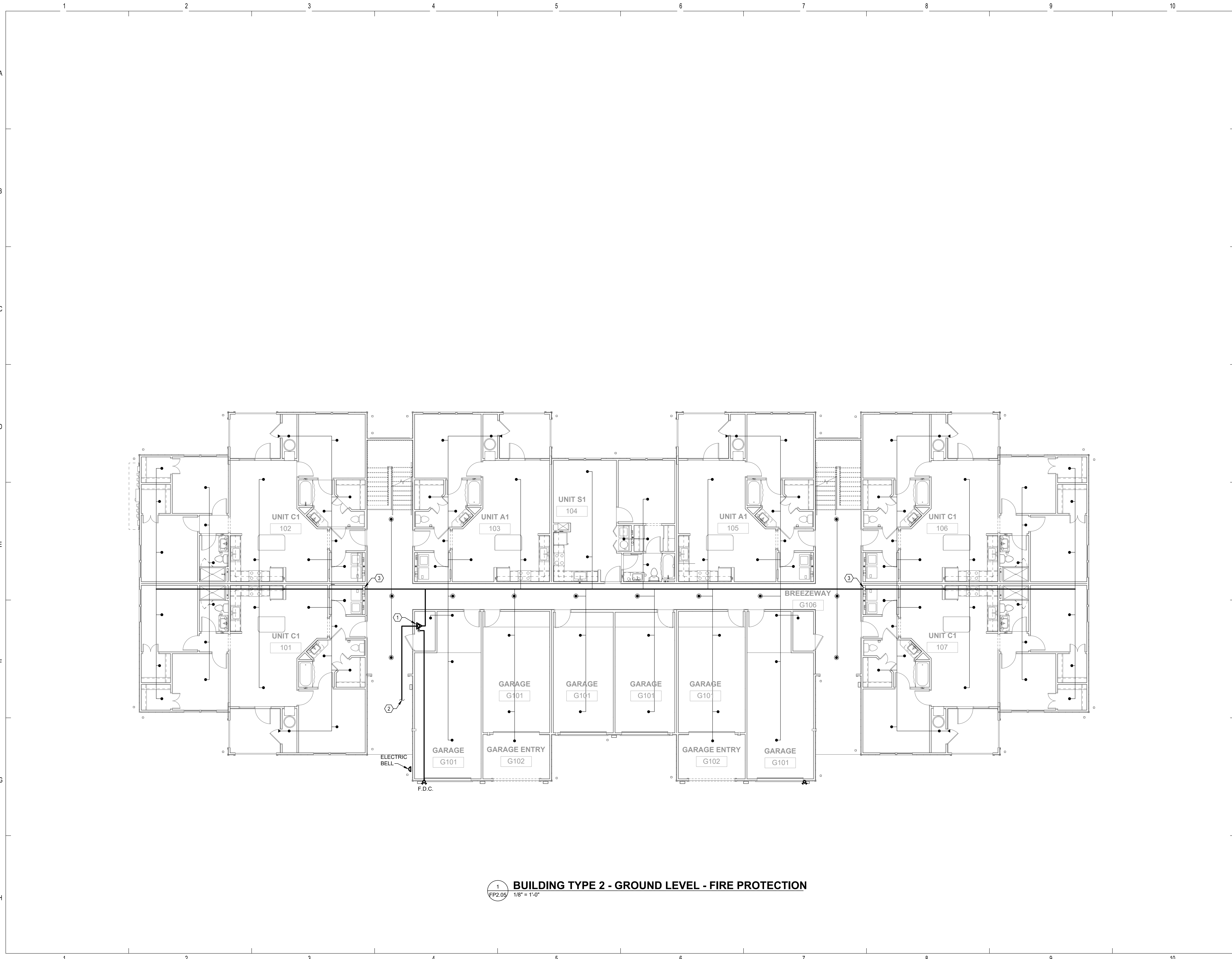

REFERENCE NOTES

- ① 3" FIRE RISER. SEE DETAIL.
- ② FOR CONTINUATION, REFER TO CIVIL DRAWINGS.
- ③ FIRE LINE UP TO FLOOR ABOVE.

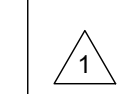

PERMIT REVIEW STAMP

ISSUE HISTORY

No.	Date	Description
1	11/22/19	SCHEMATIC DESIGN
2	12/06/19	DESIGN DEVELOPMENT
3	02/28/20	PERMIT REVIEW SET

REVISION HISTORY

No.	Date	Description
1	05/06/20	PERMIT COMMENT RESPONSES

FUGLEBERG KOCH
 PLLC
 2555 Temple Trail, Winter Park, FL 32789 (407) 629-0595
 www.fuglebergkoch.com BR569

CONSULTANT
SALAS O'BRIEN
 [expect a difference]
 3901 Quindange Boulevard, Suite 100
 Orlando, Florida 32817
 (407) 388-6800
 CERT. OF AUTH. NO. 6166

THIS ITEM HAS BEEN ELECTRONICALLY SIGNED AND SEALED BY: JEFFREY A. KORSMAN, PE ON DATE INDICATED IN DIGITAL SIGNATURE USING A DIGITAL SIGNATURE.
 PRINTED COPIES OF THIS DOCUMENT ARE NOT CONSIDERED SIGNED AND SEALED AND THE SIGNATURE MUST BE VERIFIED ON ANY ELECTRONIC COPIES.

Drawn:	SWC
Checked:	RDP
Approval:	JAK
Date:	09/10/2019
Project #:	5582

THE ROBERT
 FT. MYERS, FL

BUILDING TYPE 2 - GROUND LEVEL - FIRE PROTECTION

FP2.05

1 BUILDING TYPE 2 - GROUND LEVEL - FIRE PROTECTION
 FP2.05 1/8" = 1'-0"

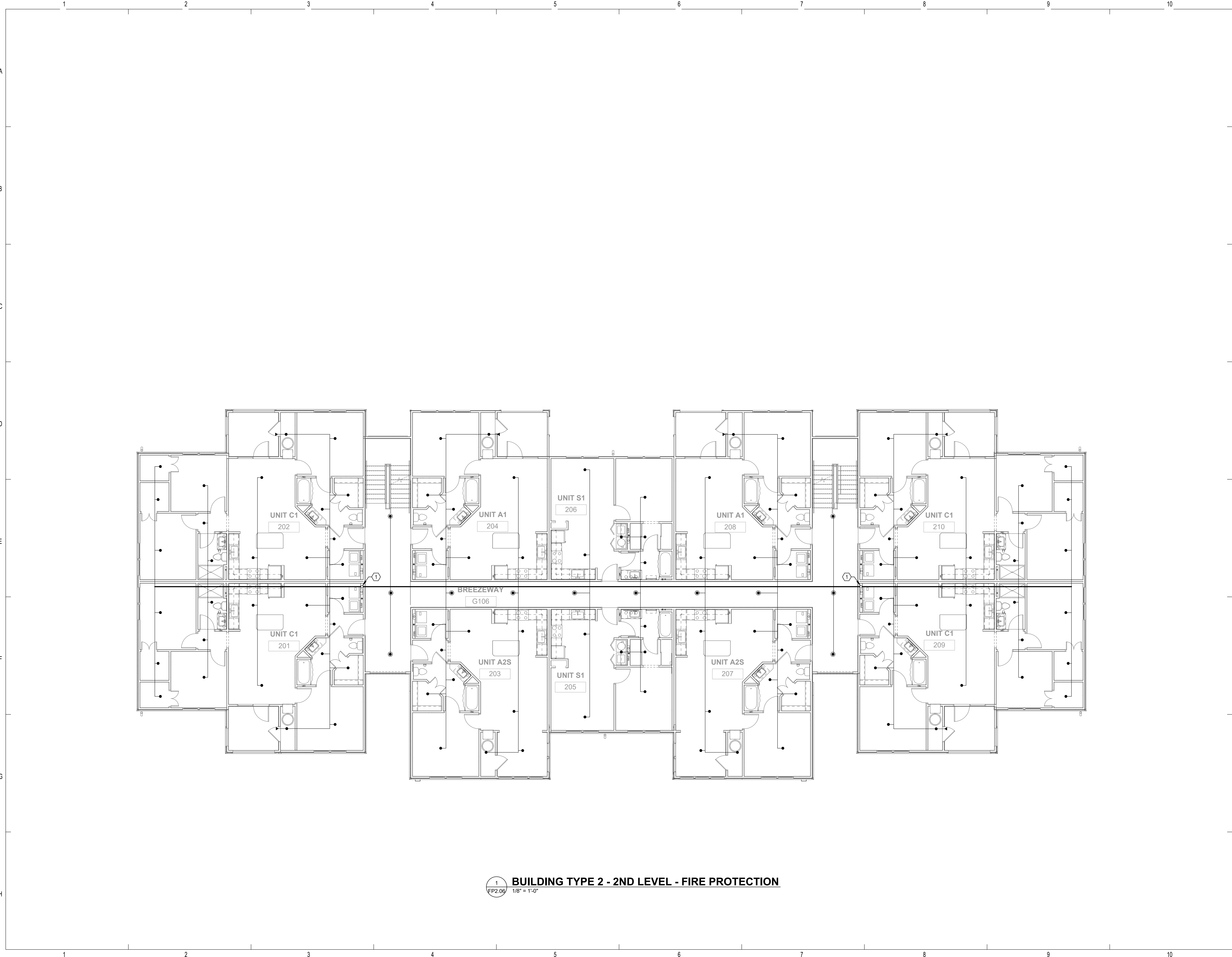

REFERENCE NOTES

① FIRE LINE UP FROM BELOW.



PERMIT REVIEW STAMP

ISSUE HISTORY

No.	Date	Description
1	11/22/19	SCHEMATIC DESIGN
2	12/06/19	DESIGN DEVELOPMENT
3	02/28/20	PERMIT REVIEW SET

REVISION HISTORY

No.	Date	Description
1	05/06/20	PERMIT COMMENT RESPONSES



FUGLEBERG KOCH
PLLC

2555 Temple Trail, Winter Park, FL 32789 (407) 629-0595
www.fuglebergkoch.com BR569

CONSULTANT

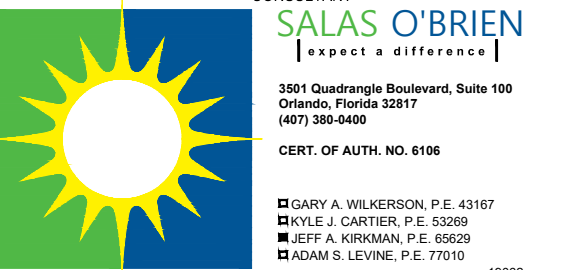

3901 Quailridge Boulevard, Suite 100
Orlando, Florida 32817
(407) 388-6800
CERT. OF AUTH. NO. 6106

THIS ITEM HAS BEEN ELECTRONICALLY SIGNED AND SEALED BY: JEFFREY A. KORSMAN, PE ON DATE INDICATED IN DIGITAL SIGNATURE USING A DIGITAL SIGNATURE.
PRINTED COPIES OF THIS DOCUMENT ARE NOT CONSIDERED SIGNED AND SEALED AND THE SIGNATURE MUST BE VERIFIED ON ANY ELECTRONIC COPIES.

THE ROBERT

FT. MYERS, FL

Drawn:	SWC
Checked:	RDP
Approval:	JAK
Date:	09/10/2019
Project #:	5582

BUILDING TYPE 2 - 2ND LEVEL - FIRE PROTECTION

FP2.06

1 BUILDING TYPE 2 - 2ND LEVEL - FIRE PROTECTION
FP2.06 1/8" = 1'-0"

© 2019 These documents and their contents are the property of FUGLEBERG KOCH-LLC and are issued only for the specific project noted on these drawings. Any reproduction, revision, or modification of these documents without the expressed written consent of Fugleberg Koch, is prohibited by law.

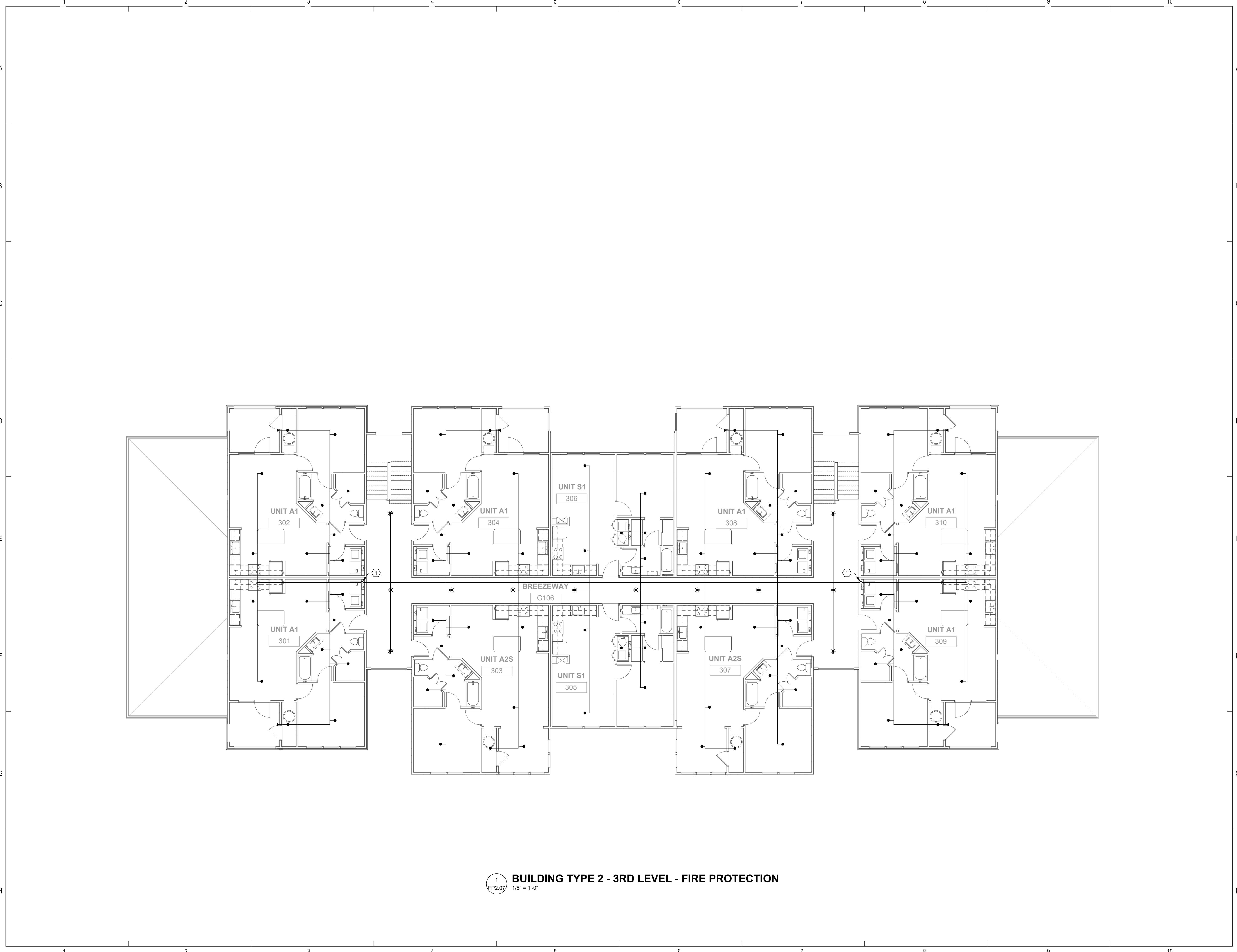

REFERENCE NOTES

- ① FIRE LINE UP FROM BELOW.

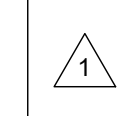

PERMIT REVIEW STAMP

ISSUE HISTORY

No.	Date	Description
1	11/22/19	SCHEMATIC DESIGN
2	12/06/19	DESIGN DEVELOPMENT
3	02/28/20	PERMIT REVIEW SET

REVISION HISTORY

No.	Date	Description
1	05/06/20	PERMIT COMMENT RESPONSES

FUGLEBERG KOCH
 PLLC
 2555 Temple Trail, Winter Park, FL 32789 (407) 629-0595
 www.fuglebergkoch.com BR569

CONSULTANT
SALAS O'BRIEN
 |Expect a difference|
 3901 Quincewage Boulevard, Suite 100
 Orlando, Florida 32817
 (407) 388-6800
 CERT. OF AUTH. NO. 6106

THIS ITEM HAS BEEN ELECTRONICALLY SIGNED AND SEALED BY JEFFREY A. KORSMAN, PE ON DATE INDICATED IN DIGITAL SIGNATURE USING A DIGITAL SIGNATURE.
 PRINTED COPIES OF THIS DOCUMENT ARE NOT CONSIDERED SIGNED AND SEALED AND THE SIGNATURE MUST BE VERIFIED ON ANY ELECTRONIC COPIES.

Drawn:	SWC
Checked:	RDP
Approval:	JAK
Date:	09/10/2019
Project #:	5582

THE ROBERT
 FT. MYERS, FL

BUILDING TYPE 2 - 3RD LEVEL - FIRE PROTECTION

FP2.07

BUILDING TYPE 2 - 3RD LEVEL - FIRE PROTECTION
 1/8" = 1'-0"

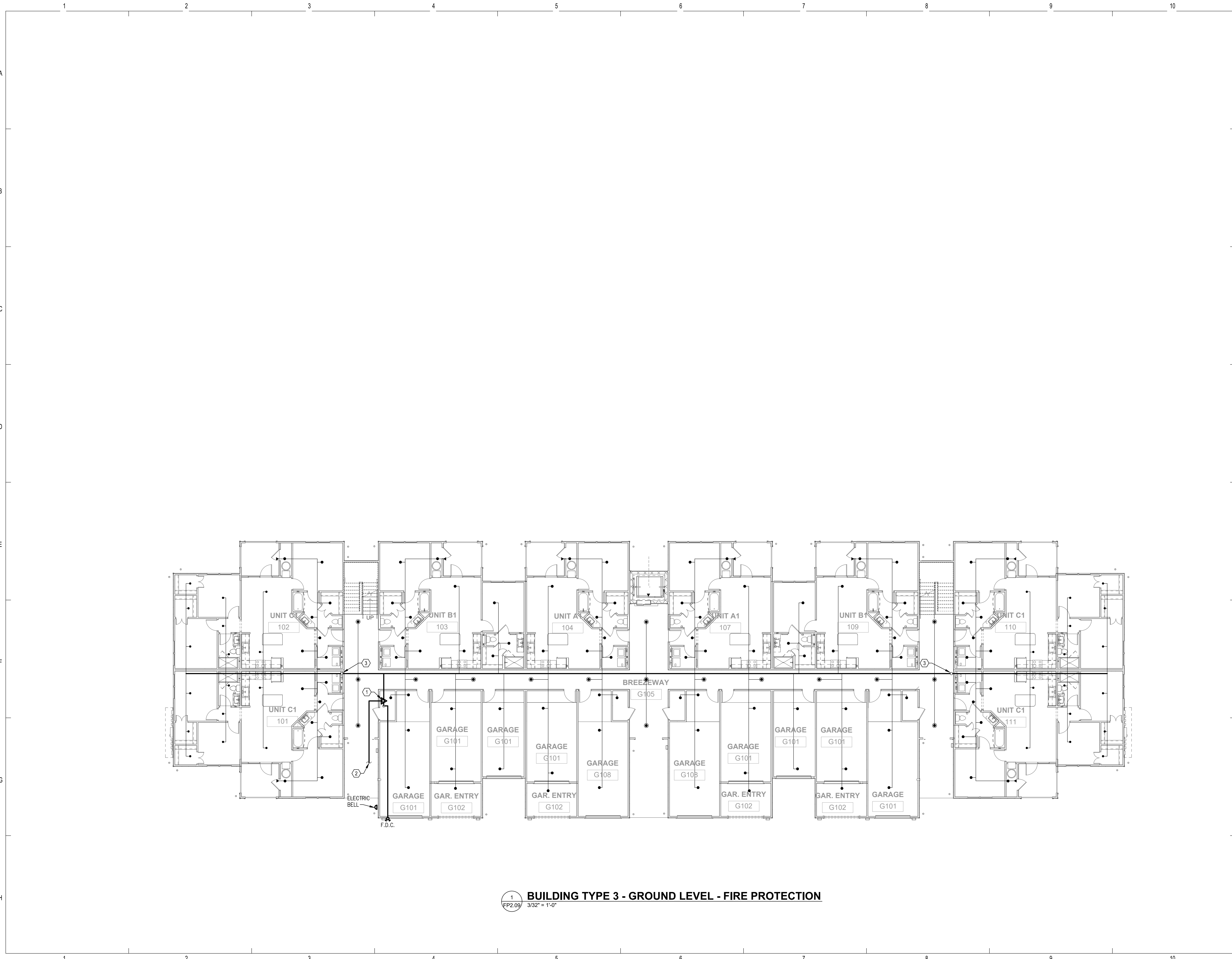

REFERENCE NOTES

- ① 3" FIRE RISER. SEE DETAIL.
- ② FOR CONTINUATION, REFER TO CIVIL DRAWINGS.
- ③ FIRE LINE UP TO FLOOR ABOVE.

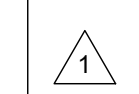

PERMIT REVIEW STAMP

ISSUE HISTORY

No.	Date	Description
1	11/22/19	SCHEMATIC DESIGN
2	12/06/19	DESIGN DEVELOPMENT
3	02/28/20	PERMIT REVIEW SET

REVISION HISTORY

No.	Date	Description
1	05/06/20	PERMIT COMMENT RESPONSES

2555 Temple Trail, Winter Park, FL 32789 (407) 629-0595
www.fuglebergkoch.com BR569

CONSULTANT
SALAS O'BRIEN
Expect a difference

3901 Quince Orchard, Suite 100
Gaithersburg, MD 20878
(410) 380-6800
CERT. OF AUTH. NO. 6106

10062
GARY A. WILKINSON, P.E. 43167
MICHAEL J. CARTER, P.E. 63009
JEFF A. KORHMAN, P.E. 66029
MICHAEL S. LEVINE, P.E. 77019

THIS ITEM HAS BEEN ELECTRONICALLY SIGNED AND SEALED BY: JEFFREY A. KORHMAN, PE ON DATE INDICATED IN DIGITAL SIGNATURE USING A DIGITAL SIGNATURE.
PRINTED COPIES OF THIS DOCUMENT ARE NOT CONSIDERED SIGNED AND SEALED AND THE SIGNATURE MUST BE VERIFIED ON ANY ELECTRONIC COPIES.

Drawn:	SWC
Checked:	RDP
Approval:	JAK
Date:	09/10/2019
Project #:	5582

THE ROBERT
FT. MYERS, FL

BUILDING TYPE 3 - GROUND LEVEL - FIRE PROTECTION

FP2.09

1 **BUILDING TYPE 3 - GROUND LEVEL - FIRE PROTECTION**
FP2.09 3/32" = 1'-0"

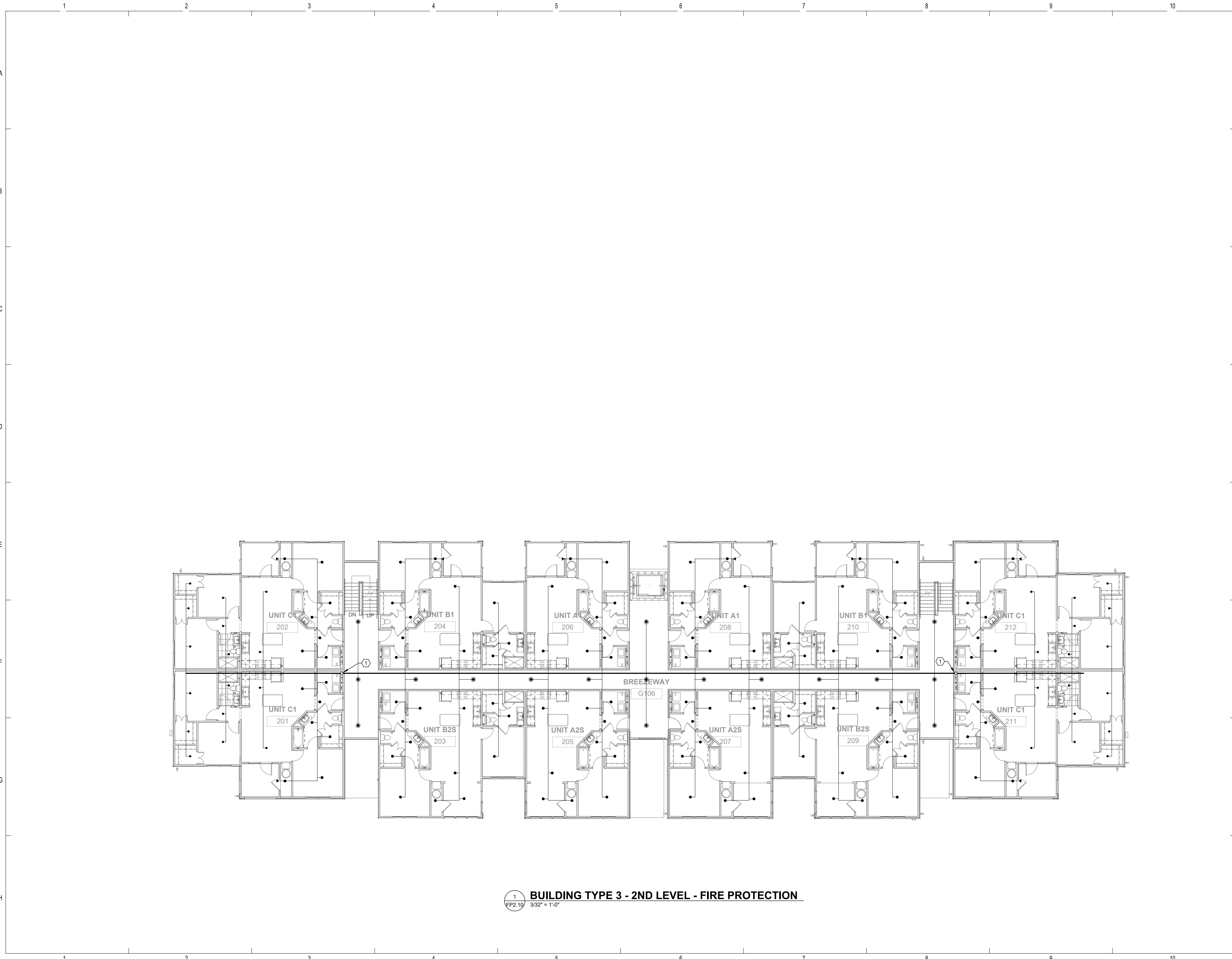

REFERENCE NOTES

① FIRE LINE UP FROM BELOW.

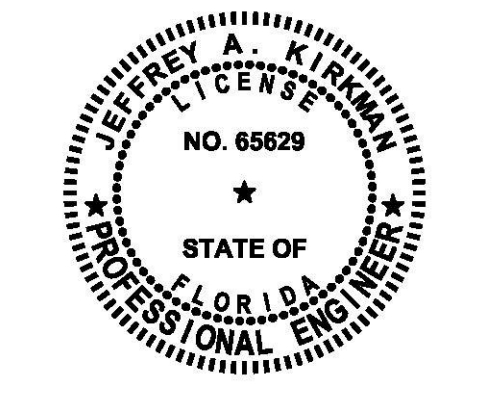
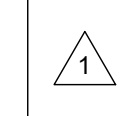

PERMIT REVIEW STAMP

ISSUE HISTORY

No.	Date	Description
1	11/22/19	SCHEMATIC DESIGN
2	12/06/19	DESIGN DEVELOPMENT
3	02/28/20	PERMIT REVIEW SET

REVISION HISTORY

No.	Date	Description
1	05/06/20	PERMIT COMMENT RESPONSES

THIS ITEM HAS BEEN ELECTRONICALLY SIGNED AND SEALED BY: JEFFREY A. KIRKMAN, PE ON DATE INDICATED IN DIGITAL SIGNATURE USING A DIGITAL SIGNATURE.
 PRINTED COPIES OF THIS DOCUMENT ARE NOT CONSIDERED SIGNED AND SEALED AND THE SIGNATURE MUST BE VERIFIED ON ANY ELECTRONIC COPIES.

Drawn:	SWC
Checked:	RDP
Approval:	JAK
Date:	09/10/2019
Project #:	5582

THE ROBERT
 FT. MYERS, FL

BUILDING TYPE 3 - 2ND LEVEL - FIRE PROTECTION

FP2.10

① **BUILDING TYPE 3 - 2ND LEVEL - FIRE PROTECTION**
 FP2.10 3/32" = 1'-0"

© 2019 These documents and their contents are the property of FUGLEBERG KOCH, and are issued only for the specific project noted on these drawings. Any reproduction, revision, or modification of these documents without the expressed written consent of Fugleberg Koch, is prohibited by law.

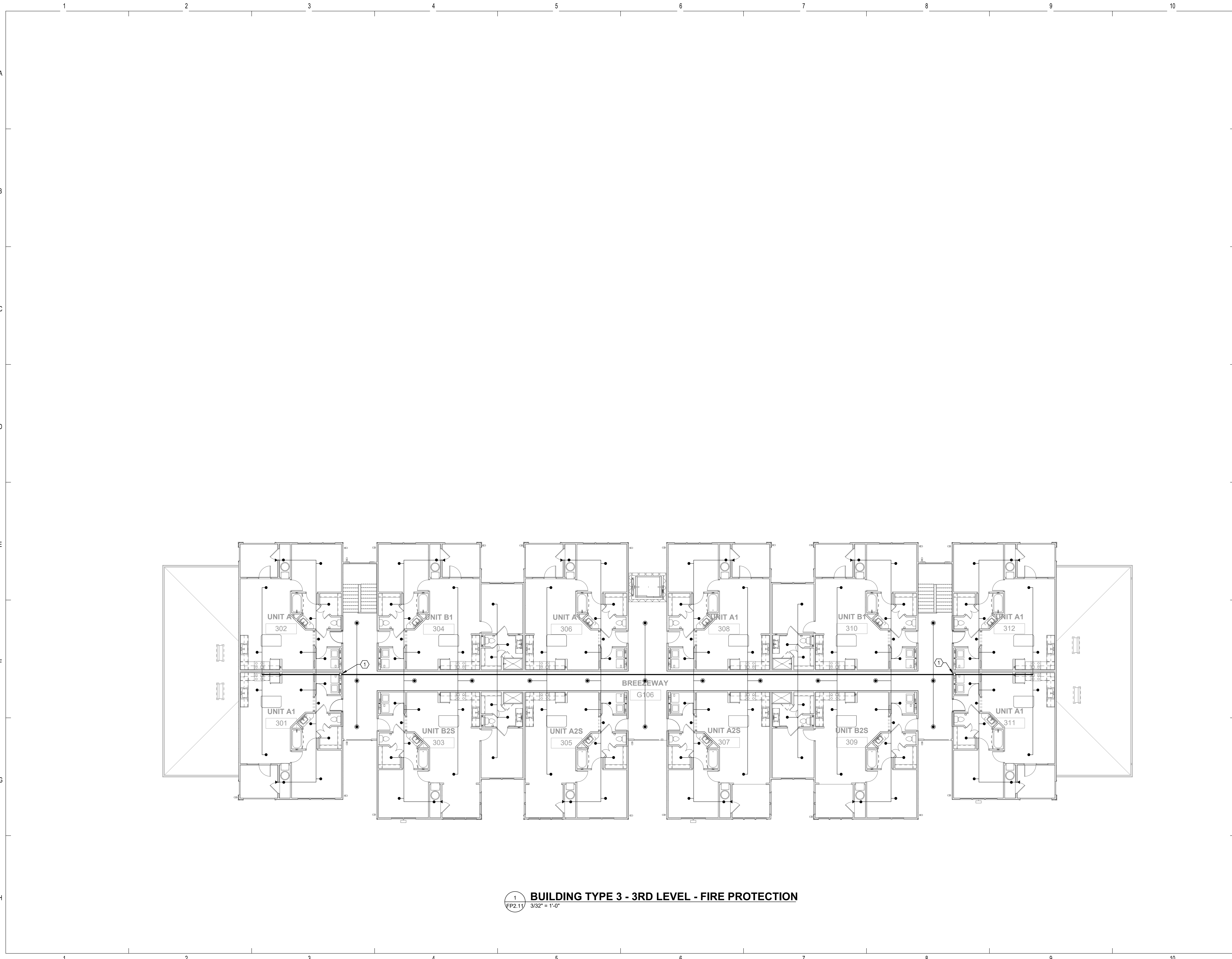

REFERENCE NOTES

- ① FIRE LINE UP FROM BELOW.

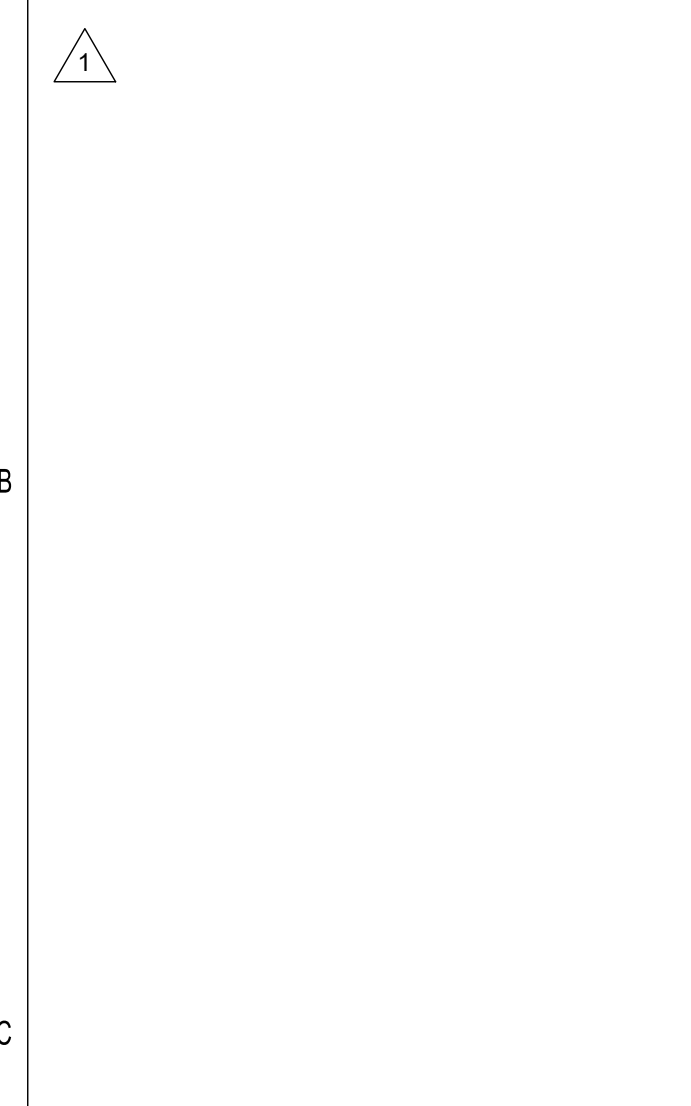

PERMIT REVIEW STAMP

ISSUE HISTORY

No.	Date	Description
1	11/22/19	SCHEMATIC DESIGN
2	12/06/19	DESIGN DEVELOPMENT
3	02/28/20	PERMIT REVIEW SET

REVISION HISTORY

No.	Date	Description
1	05/06/20	PERMIT COMMENT RESPONSES

FUGLEBERG KOCH
 PLLC
 2555 Temple Trail, Winter Park, FL 32789 (407) 629-0595
 www.fuglebergkoch.com BR569

CONSULTANT
SALAS O'BRIEN
Expect a difference
 3901 Quince Orchard Boulevard, Suite 100
 Gaithersburg, MD 20878
 (410) 386-6800
 CENT. OF ARCH. NO. 6106

THIS ITEM HAS BEEN ELECTRONICALLY SIGNED AND SEALED BY: JEFFREY A. KORSMAN, PE ON DATE INDICATED IN DIGITAL SIGNATURE USING A DIGITAL SIGNATURE.
 PRINTED COPIES OF THIS DOCUMENT ARE NOT CONSIDERED SIGNED AND SEALED AND THE SIGNATURE MUST BE VERIFIED ON ANY ELECTRONIC COPIES.

Drawn: SWC
Checked: RDP
Approval: JAK
Date: 09/10/2019
Project #: 5592

THE ROBERT
 FT. MYERS, FL

BUILDING TYPE 3 - 3RD LEVEL - FIRE PROTECTION

FP2.11

① **BUILDING TYPE 3 - 3RD LEVEL - FIRE PROTECTION**
 FP2.11 3/32" = 1'-0"

© 2019 These documents and their contents are the property of FUGLEBERG KOCH. All rights reserved. Any reproduction, revision, or modification of these documents without the expressed written consent of Fugleberg Koch is prohibited by law.